



# ORIGINAL AIR GROUP

*The Factory A/C Experts*



**CLASSIC  
Auto Air**

## 1958 - 66 THUNDERBIRD

### FACTORY AIR CONDITIONING PARTS

3RD EDITION, VOLUME 1



# From Classic Auto Air

---

Dear Enthusiast,

As a result of our passionate dedication to the hobby, Classic Auto Air has remained the A/C and heating industry leader since 1977, supplying factory or aftermarket, parts and systems for 1970's & older Ford, GM and Chrysler vehicles.

On behalf of all the talented people here at Classic Auto Air, I would like to express our deep felt gratitude to all the enthusiast and dealers who have supported us and shared in our success for so many years. We hope our products have had a positive impact on your business and our wonderful hobby.

These are exciting times at Classic Auto Air. After 5 years of extensive research and development, the 1999 season saw the introduction of our revolutionary new *Perfect Fit Series* systems. With over 50 different model specific systems the *Perfect Fit Series* is now firmly established as the highest quality, best performing systems in the industry!

An extremely efficient, in-dash, heat/cool and defrost total climate control system that replaces the old heat/defrost box. The factory heater panel controls the system. Stock dash vent locations on most applications for that sought after – but until now, rarely achieved – factory air appearance! Large, separate coils and floor / dash (bi-level) A/C and heat with dehumidified defrost provide the driver with total airflow control and superior passenger comfort in all climates.

The *Perfect Fit Series* systems represent the state of the art in classic/muscle car air conditioning technology. Classic Auto Air's excellent reputation for uncompromised quality, component selection and attention to detail is evident in all aspects of the *Perfect Fit Series* product line. Every component was chosen based on its superior design, durability and quality rather than a low cost. These feature rich OEM style systems are computer designed for robust, maximum performance and a "Perfect Fit" every time!

Conversion to environmentally friendly 134a refrigerant has become extremely popular. Our high performance Sanden compressor conversion kits have become the industry standard when converting to 134a. Excellent attention to detail provide an easy installation and attractive under hood appearance. Performance levels are equal to or better than R-12.

In addition, we are also very excited about the release of our first edition catalog for 1958-66 Ford Thunderbirds.

A comprehensive inventory assures your order will be complete and processed in a timely manner. Should you have any questions about our products, installation or troubleshooting always feel free to call. Our knowledgeable staff is always glad to assist you. See why "cool" enthusiasts everywhere are proud to say, "My ride has Classic Air".

Stay Cool,

From all of us at Classic Auto Air!

# Air-Conditioning Basics

Mobile air-conditioning systems consist of 5 main component groups: the compressor, the compressor mount and drive, the evaporator/blower assembly (passenger compartment), the condenser (engine compartment), and the hose set with a filter/drier.

The best way to understand how an automotive air-conditioning system works is to follow the refrigerant cycle. (Study the refrigerant cycle diagram)

The compressor pumps heat-laden low-pressure vapor refrigerant cycled back from the evaporator. This is then compressed into a high-pressure vapor and sent to the condenser. The vapor is much hotter than the outside air and this heat is given up to the outside air as it passes through the condenser. As the refrigerant vapor heat load drops, it condenses into a liquid that is passed along to the filter/drier where it is filtered, dried, and stored. The filter/drier pick-up tube goes to the bottom of the unit to insure that a solid stream of compressed liquid, without vapor, is supplied to the evaporator. The expansion valve controls this flow of refrigerant into the evaporator. The pressure on the evaporator side of the expansion valve is approximately 10 times lower, allowing the refrigerant to expand rapidly or boil, changing back to vapor as it moves through the coil. As the refrigerant expands or boils, it absorbs heat from cabin air blown through the evaporator fins. The resulting cold air is then discharged through the louvers. Refrigerant exiting the evaporator as low pressure vapor returns to the compressor to start the cycle again.

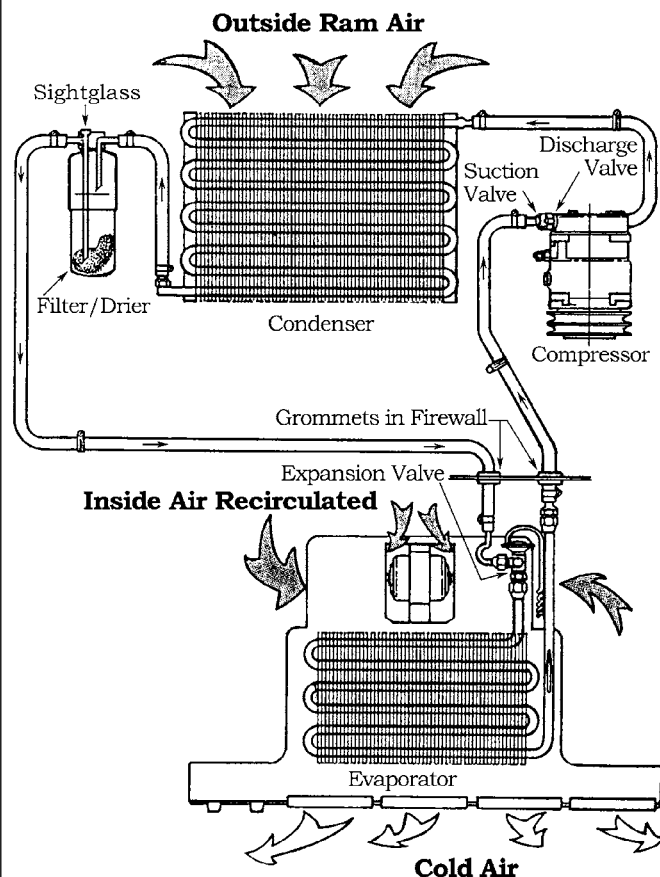

## Helpful Tips to Maintain Your A/C

With the cost of recharging a system and prices of rare parts continuing to escalate, preventative maintenance has become very important. Anytime a system has to be discharged, carefully inspect the entire system, not just the part that failed. Internal corrosion and decomposed oil caused by moisture is a serious problem on classic cars due to age and poor past maintenance. The #1 enemy of an air-conditioning system is small amounts of moisture. When as little as 20 parts per million of moisture mixes with the normally inert refrigerant, it forms hydrochloric acid. This acid corrodes the entire system. The corrosion then mixes with the decomposing oil forming sludge and increasing the chance of system failure. Always change the filter/drier and vacuum pump the system to remove residual moisture.

### Compressor:

Never install a used compressor without servicing it first. When a compressor is not run on a regular basis, the shaft seal and valve plate corrode. The seal leakage and valve plate corrosion causes poor pumping and system

performance. It is also common to see valve plates damaged by charging the system with liquid refrigerant instead of vapor. This usually happens when the charging cylinder is tipped over, allowing liquid to enter the charging hoses.

Normal oil level is 11 ounces - most compressors sent to us have only 2 to 3 ounces of oil that has become waxy and acidic. These conditions will surely cause the compressor to seize or throw a rod, contaminating the entire system.

It is best to rebuild the compressor before installation and to always replace the filter/drier.

### Compressor Mount & Drive:

Check the tightness of all bolts on the mounts, supports, idlers and pulleys. This is very important on 6 cylinder cars. Make sure idler and clutch bearings turn smoothly and quietly.

### Evaporator:

All classic cars with an original A/C system should have the evaporator reconditioned. Lacking a replaceable filter, the backside will become impacted with debris just like your



## Helpful Tips (Continued)

home's air-conditioning filter. Once this happens, air is forced *around*, not *through* the coil causing poor cooling and more rapid cycling of the compressor.

Surface corrosion builds up on the fins and tubes. This acts like an insulator causing poor heat transfer. The coil should also be flushed, purged clean and pressure tested with nitrogen. Any internal corrosion and acidic oil will be removed during this process. On indash systems the foam door seals on the evaporator box are usually deteriorated. In severe cases the door itself is partially rusted away. So while the evaporator is out of the box, rebuild the box also.

### Condenser:

The most important factor in determining how cold and efficient a system operates is the condenser. Cabin temperature and system pressures increase as condenser condition deteriorates. High system pressures place an excessive load on the compressor and clutch causing premature failure. Increased fan belt slapping, vibration, rumble and poor engine performance also contribute to poor A/C performance or failure. Mustangs use an all aluminum condenser that is very efficient, but also very prone to corrosion.

Common problems include bad threads, loose fins and internal corrosion. Fin separation usually starts at the top and/or bottom, progressing toward the center. Gluing

them back into place **will not** increase performance. Internal corrosion is a white powder material that forms on the inside as the tubes deteriorate. These are all serious problems requiring condenser replacement.

### Hose Set & Filter/Drier:

Rubber hoses should be replaced if there are any signs of dry-rot or cracking, or if you can rotate the hose independent from the fitting and/or crimp sleeve. Nylon hose becomes brittle with age and cannot withstand being kinked or flattened. A permanent oval can be felt where the kink occurred. Kinks and exhaust burns are the most common causes of failure in nylon hose.

Like the oil filter on any car engine, the filter/drier is a throw-away part! Also known as a receiver/drier, the component serves as a storage container for high pressure liquid. Internally there are filters and a dessicant to clean and remove small amounts of moisture from the refrigerant. Clogged filters or excess moisture vapor usually cause expensive component failure. **Change the filter/drier anytime the system has been fully discharged.** Look at it as inexpensive insurance toward years of trouble-free service.

## Ordering & Policy Information

### Order by Phone (813) 251-2356

Our phone lines are open Monday through Friday from 9:30 a.m. to 6:00 p.m. EST. Most parts orders are shipped within 24 hours via United Parcel Service (U.P.S.) Prepayment can be made by Mastercard or VISA or your order will be shipped on a Cash-on-delivery (C.O.D.) basis. Payment to the UPS driver can be made by certified funds — a bank check, or money order in U.S. Funds. **UPS does not accept cash.** Checks should be made to Classic Auto Air, not U.P.S. If you are not home during the day, we will accept a "ship to" address and have your order delivered to a friend, relative, or your workplace.



\*Cash is not accepted by UPS.

### Order by Mail 5133 W Idlewild Ave, Tampa, FL 33634

Mail orders accompanied by a certified check, money order, or credit card information will be processed immediately. Credit card orders require a Mastercard or VISA account number, Cardholder's name, and account expiration date. Orders received with personal or company checks are gladly accepted, but please allow up to 2 weeks to insure clearance. Please make checks payable to Classic Auto Air Mfg. Co.

### Order by Phone/Mail

Our sales team will be glad to take your order by phone and assist you in placing a **technically complete and accurate order**. You'll be given an exact total including shipping and handling. Mail or overnight the payment to us. Payment by bank check or money order will be processed immediately. Personal or company checks are gladly accepted, but please allow up to 2 weeks to insure clearance.

# Ordering & Policy Information

## Order by Fax (813) 254-7419

Our fax line is available 24-hours a day, seven days a week. Most parts orders are shipped via United Parcel Service (U.P.S.) within 24 hours of the first business day following receipt of the order. Prepayment can be made by including credit card information. Credit card orders require a Mastercard, VISA, Discover or American Express account number and expiration date, 3 or 4 digit security code, cardholder's name, billing address and signature.

Should you wish to prepay your fax order by mailing a check or certified funds, note that on the order form. We will fax or phone you back with the exact total including shipping and handling.

## 800 Phone #

Due to the low-volume, highly seasonal nature of our business, C.A.A. does not have an 800 number. Time has shown this to be a major area in which we can work together with our customers to significantly control expenses. Our goal is to provide quality products at acceptable prices, combined with the added value of a year-round knowledgeable staff ready to answer your most difficult technical questions.

## Overseas Orders

We ship worldwide and use Air Parcel Post for small and/or lightweight orders. All large or heavyweight shipments are sent by Air Freight. The air freight forwarder we use has excellent rates and service. If you prefer we can also use U.P.S., Federal Express, Airborne, or the carrier of your choice.

Phone or fax you order. We will then phone or fax you back with the exact cost of the order including shipping and handling. Payment must be made by VISA, Mastercard, or an international money order in U.S. funds. Sorry, no bank wire transfers. If the order is urgent, send payment by overnight express service. Most parts orders are shipped within 24 to 48 hours of receipt.

## Sales Tax

No sales tax is charged on orders shipped out-of-state. Residents of **Florida** and **Texas** are subject to **sales tax on all orders**. Sales tax exemptions are granted to companies furnishing their sales tax exemption number.

## Back Orders

We try very hard to have all catalog items in stock at all times, however, due to scarcity and long lead times from our manufacturers, some parts can be temporarily out of stock. If the item will be back in stock in a short time period, you will be charged for the part on the original order. We will ship, prepaid, as soon as possible. Should the backorder be longer, you will not be charged on the original invoice. Your invoice will be noted "backorder" for any parts that were out of stock. Back ordered items will be shipped the same day our stock is replenished. Back orders can be cancelled at any time, unless already shipped.

## Warranties

C.A.A. will replace or repair any defective part for a period of 90 days, systems for 3 years - providing the same part is not covered for a longer period by the original manufacturer. Warranty is immediately void should any refrigerant or additive be installed into the system other than R-12 or 134a. We are here to help — call us immediately so we may authorize the return and send a replacement part. Properly package the item, we will have it picked up and returned to us at no cost to you. A copy of the original invoice and a short, detailed explanation must be enclosed with the merchandise.

This warranty is for parts replacement only. We do not cover labor, refrigerants, or any other item not supplied by C.A.A. The company shall not be responsible or subjected to any action for damages. There are no conditions, representations, or warranties, expressed or implied, statutory or otherwise, except those herein contained.

## Damaged Merchandise

**Please open and inspect your order as soon as it arrives.** If you believe you are missing a part or parts, call us immediately.

All damage resulting from shipping is the responsibility of the carrier. **Keep all packing material with the box and parts.** Immediately notify the carrier and then call us with the invoice number from the package label. We will be glad to assist you in filing a fast and accurate claim with the carrier.

## Returns / Refunds

All special orders and electrical parts are non-returnable. **Parts and systems may be returned within 30 days for a refund or exchange. Missing parts must be reported within 5 days of receiving your order. Please call or write for authorization before returning any part.** All returns must be uninstalled and in undamaged factory packaging so we may resell the parts as new. All returns must be shipped freight prepaid to C.A.A. with a copy of the original invoice enclosed. All refunds will be subject to a 15% administrative/restocking charge.





# Ordering & Policy Information

## Returns / Refunds (Continued)

Refunds on properly returned merchandise will be credited to customer's account. Credit memos may be used on future orders or customer can request a cash refund. Allow 30 days from date C.A.A. receives returned merchandise.

## Parts Origin Disclaimer

The items in this catalog are a combination of the highest quality reproduction, rebuilt original, and new original parts. Always feel free to call for detailed information on any of the products we sell.

## Pricing

Due to price increases charged by our suppliers, we reserve the right to change prices or withdraw products without prior notice. Please call to check pricing and availability.

## Shipping Policies

We have found the majority of our U.S. and Canadian customers prefer United Parcel Service (U.P.S.) Standard U.P.S. shipping is ground service, although we offer 2nd day and next day air services.

Find your zone by locating the first 3 digits of your zip code on the chart below. **All residents of zones 2 and 3 add 5% for shipping and handling. Zones 4 through 8 add 10%. Minimum shipping charge is \$9.95 within the lower 48 states.**

Should you wish 2nd day or next day air services, call or fax us for exact shipping and handling charges. All shipments to Hawaii, Alaska, and Puerto Rico are 2nd day and next day air only.

## Original Complete System Shipping Charges

Zone	Amount
2 .....	\$47.00
3 .....	\$53.00
4 .....	\$57.00
5 .....	\$63.00
6 .....	\$67.00
7 .....	\$73.00
8 .....	\$83.00

Zip begins...	Zone	Zip begins...	Zone	Zip begins...	Zone	Zip begins...	Zone
004-005 .....	5	325 .....	4	594-599 .....	8	764-767 .....	5
006-007 .....	-	326-329 .....	2	600-601 .....	5	768-769 .....	6
008 .....	-	330-332 .....	3	602 .....	6	770-787 .....	5
009 .....	-	333-339 .....	2	603-609 .....	5	788 .....	6
010-046 .....	6	340 .....	-	610-612 .....	6	789 .....	5
047 .....	7	341-349 .....	2	613-634 .....	5	790-797 .....	6
048-069 .....	6	350-362 .....	4	635 .....	6	798-799 .....	7
070-089 .....	5	363 .....	3	636-639 .....	5	800-820 .....	7
090-099 .....	-	364-369 .....	4	640-647 .....	6	821 .....	8
100-105 .....	5	370-372 .....	5	648 .....	5	822-830 .....	7
106 .....	6	373-374 .....	4	649 .....	6	831-851 .....	8
107-108 .....	5	375 .....	5	650-659 .....	5	852 .....	7
109 .....	6	376-379 .....	4	660-666 .....	6	853-854 .....	8
110-118 .....	5	380-384 .....	5	667 .....	5	855-860 .....	7
119-146 .....	6	385 .....	4	668-672 .....	6	863-864 .....	8
147 .....	5	386-387 .....	5	673 .....	5	865-880 .....	7
148-149 .....	6	388-399 .....	4	674-691 .....	6	881-882 .....	6
150-187 .....	5	400-483 .....	5	692-693 .....	7	883 .....	7
188 .....	6	484-489 .....	6	700-704 .....	4	884 .....	6
189-199 .....	5	490-492 .....	5	705-706 .....	5	885 .....	7
200-268 .....	5	493-499 .....	6	707-709 .....	4	889-899 .....	8
270-278 .....	4	500-563 .....	6	710-729 .....	5	900-961 .....	8
279 .....	5	564-567 .....	7	730-732 .....	6	962-966 .....	-
280-298 .....	4	570-571 .....	6	733-734 .....	5	967-968 .....	-
299 .....	3	572 .....	7	735-739 .....	6	969 .....	-
300-312 .....	4	573 .....	6	740-745 .....	5	970-986 .....	8
313-317 .....	3	574-587 .....	7	746 .....	6	987 .....	-
318-319 .....	4	588-592 .....	8	747-762 .....	5	988-994 .....	8
320-324 .....	3	593 .....	7	763 .....	6	995-999 .....	-

# Table of Contents

---

Air Conditioning Basics .....	3
Helpful Tips .....	3-4
Ordering & Policy Information .....	4-6
1955 - 1966 Perfect Fit Series Complete Systems .....	8-9
1958 - 1960 Passenger Compartment .....	10-12
1958 - 1960 Engine Compartment .....	13-14
1961 - 1963 Passenger Compartment .....	15-17
1961 - 1963 Engine Compartment .....	18-19
1964 - 1966 Passenger Compartment .....	20-21
1964 - 1966 Engine Compartment .....	23-24
1967 & Newer .....	25
1958 - 1966 Compressors .....	26-27
1958 - 1966 Compressor Upgrade Kits .....	28
Photographs .....	29

---

## Abbreviations

A/C = Air-conditioning  
Adj = Adjustable  
Alt = Alternator  
Alum = Aluminum  
Assy = Assembly  
Brkt = Bracket  
Comp = Compressor

CS = Crankshaft  
Cyl = Cylinder  
Evap = Evaporator  
F/D = Filter/Drier  
Gen = Generator  
Hdwe = Hardware  
ID = Inside diameter

LH = Left Hand  
M/F = Male/Female  
Mt = Mount  
PS = Power Steering  
RH = Right Hand  
Svc = Service (Valves)  
WP = Water pump



# A Perfect Fit For Classic Thunderbird Owners

**Beat the Heat** with Classic Auto Air's all new ultra high performance "*Perfect Fit Series*" systems. An extremely efficient, in-dash, heat/cool and defrost total climate control system that replaces the old heater/defrost box. Designed specifically for each year, make and model. The factory heater panel controls the system. Stock dash vent locations on most applications for that sought after – but until now, rarely achieved – factory air appearance! Floor and dash (bi-level) A/C and heat with dehumidified defrost provide the driver with total airflow control and superior passenger comfort in all climates.

Large separate heat and A/C coils are very important features exclusive to the ***Perfect Fit Series***.

Under the hood, Sanden's state-of-the-art compressor

creates an attractive appearance and is also available polished. High performance engines and A/C are now a "perfect marriage". Sanden's high efficiency compressors require an insignificant amount of horsepower and have a 6,000 rpm continuous duty rating. High performance reproduction condensers installed in factory provided locations produce an ease of installation and higher resale values never before seen in the aftermarket A/C industry. Each system is supplied with very detailed, photo-illustrated instructions.

Uncompromised quality, component selection and attention to detail are why enthusiasts everywhere are proud to say "*My Ride has Classic Air*".

Simply stated – **No other system compares!**

## ABOUT THE PRODUCT

Classic Auto Air's excellent reputation for uncompromised quality, component selection and attention to detail is evident in all aspects of the "*Perfect Fit Series*" product line! Every component was chosen based on it's superior design, durability and quality rather than a low cost.

**Engineered with large separate A/C and heat coils just like factory air (OEM) systems.** Beware of small "Hot Rod" type systems with only one coil. When part of the cooling coil is used as a heater, total system performance is compromised and the heater tubes can freeze and burst. Flooded, ruined interiors are never a concern due to this exclusive Perfect Fit Series feature. Remember, smaller is never better when it comes to coil/case size!

**All mode doors are controlled by cables or electric servo motors. No complex maze of vacuum motors, solenoids, relays, wire and vacuum harnesses to understand and keep functioning.**

All mode doors and shafts are a high temperature, glass filled, nylon extrusion – just like OEM systems. This exclusive feature totally eliminates rusted out small diameter shafts and doors that plague the competition. Beware of "Throw-Away" type units that are totally glued shut requiring you to purchase the entire dash unit rather than a \$10 part!

Highest quality OEM control cables available. A stainless wire glides effortlessly within a nylon lined housing that never needs lubricating. Built in adjusters are an important and exclusive feature. Generic steel cables will rust and bind up. Also, without adjusters, cables are hard to service and can require dismantling the dash for periodic adjustments and lubrication.

When cables are not a practical design choice, servo motors to drive air diverter doors are a simple and ideal solution. Classic Air was first to introduce electronic servo motor drive technology!

**Latest, most advanced high output OEM-style blower assembly.** Exceptional air volume and service life with far less noise. Heat sink mounted 3 speed resistor provides dual thermal protection.

For decades Classic Auto Air has specialized in 1950s–1970s cars, most having large interior cabins. We know what it takes to keep you cool during the hottest summer months. Don't make an expensive mistake with a small, poorly made "Street Rod" type unit. Classic Auto Air's Perfect Fit Series is built to last a lifetime. These feature-rich OEM-style systems are computer designed for robust, maximum performance and a "Perfect Fit" every time!

## FEATURES

- Designed for each specific year and model car
- Smooth firewall for a clean look
- In-dash or underdash A/C vents
- Floor and dash heat/dehumidified defrost
- Stock heater control panel utilized on all models
- Designed to far outperform original and competitor systems
- Compressor Hi/Low pressure safety switch kit
- Large, separate cooling & heating coils like OEM units
- Full 3-year warranty for all 134a and R12 Systems
- OEM style doors & shafts totally eliminate rust that plagues competitor units
- Highest quality stainless steel OEM control cables with built-in adjusters or electronic servo motors
- Latest, most advanced OEM style blower assembly
- Easy to follow, very detailed photo illustrated instructions
- No rubber A/C or heater hose on interior side of firewall totally eliminates interior damage due to refrigerant oil and engine coolant hose rupture.



## 1955-57 Thunderbird

- Uses the car's original heater control panel.
- Custom condenser fan kit is standard equipment.
- Two single and one dual slim-line under-dash louvers.



## 1958-60 Thunderbird

- Uses the car's original heater control panel.
- Four slim-line dash louvers.

## 1961-63 Thunderbird

- Uses the car's original heater control panel.
- Three ball-style in-dash louvers mounted in stock location.



## 1964-66 Thunderbird

- Uses the car's original heater control panel.
- Four ball-style in-dash louvers mounted in stock location.

## Each system features...



Custom condensers with pre-formed tubes and mounting brackets designed specifically for your T-Bird!



Compressor mounting brackets and pre-made, ready to install hoses!

SYSTEMS..... \$1245.00			EVAPORATOR KITS.....\$745.00	
COMPLETE SYSTEMS			INTERIOR KITS	
	R-12	134a	IN-DASH EVAPORATOR KIT	
1955-57 Thunderbird.....	20-278	20-275	1955-57 Thunderbird.....	1-1074
1958-60 Thunderbird .....	20-294	20-293	1958-60 Thunderbird .....	1-1082
1961-63 Thunderbird .....	20-279	20-276	1961-63 Thunderbird .....	1-1075
1964-66 Thunderbird .....	20-280	20-277	1964-66 Thunderbird .....	1-1076

# 1958 - 1960 Passenger Compartment

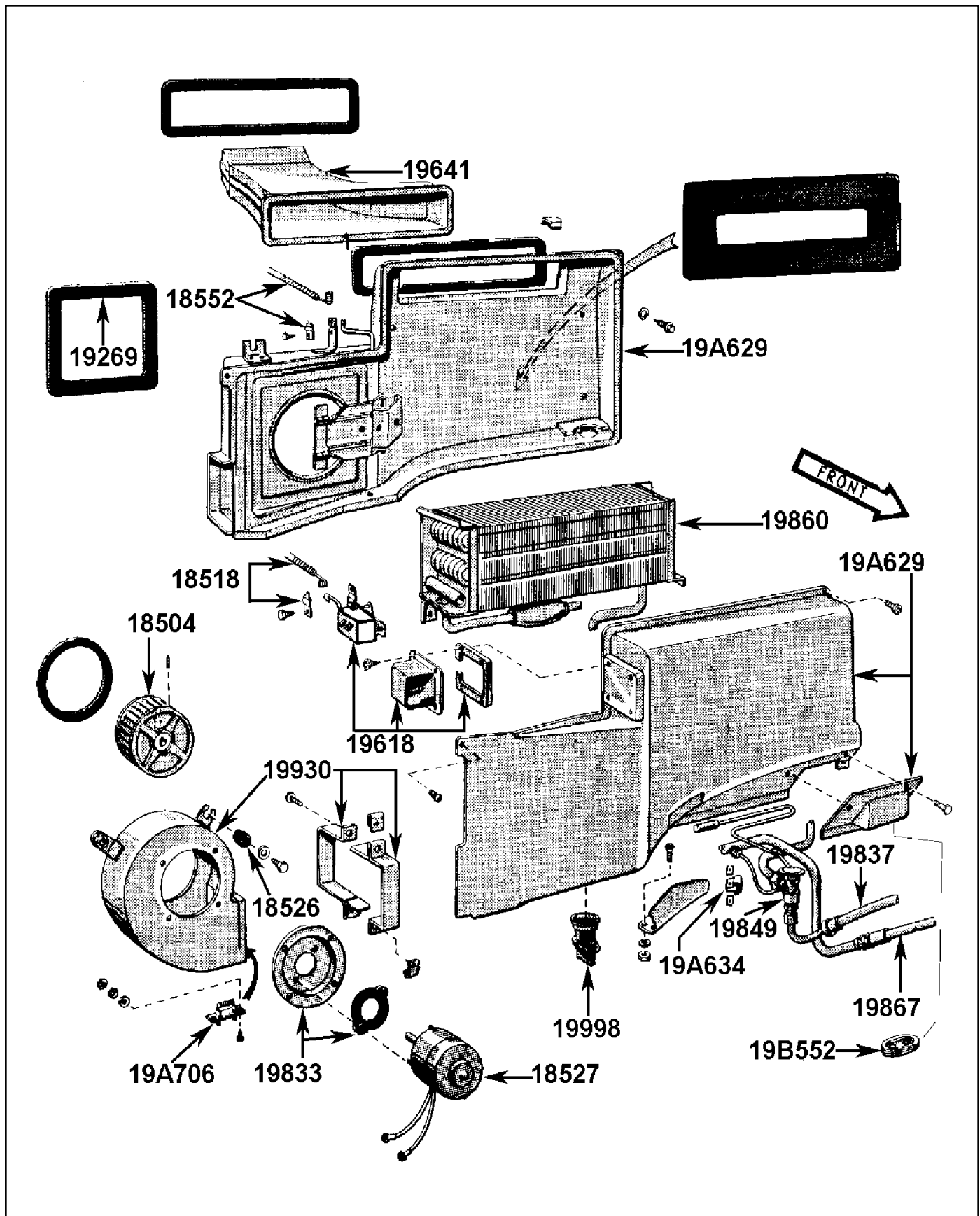

## 1958 - 1960

**18504** \_\_\_\_\_ **Blower Wheel**  
58-60 ..... Blower Wheel..... T04-101

**18518** \_\_\_\_\_ **Cable - Heat & Thermostat**  
58-60 ..... Thermostat Cable, New ..... T16-102  
58-66 ..... Cable Clamp ..... 19-152

**18526** \_\_\_\_\_ **Grommet - Blower Mounting**  
58-60 ..... Blower Mount Grommet..... n/a

**18527** \_\_\_\_\_ **Motor A/C Blower**  
58-60 ..... Blower Motor, Recond.\* ..... T04-107  
\* *Outright Core Charge, Add* ..... C-050

**18552** \_\_\_\_\_ **Cable - Recirculate**  
58..... Recirculate Cable, New ..... T16-104  
59-60 ..... Recirculate Cable, New ..... T16-105  
58-66 ..... Cable Clamp ..... 19-152

**19269** \_\_\_\_\_ **Gasket - Evaporator to Dash Panel**  
58-60 ..... Evaporator - Dash Gasket ..... n/a

**19618** \_\_\_\_\_ **Switch - Thermostat**  
58-60 ..... Thermostat Mount/Lever..... T16-124  
58-63 ..... Thermostat Body, New..... T16-118  
58-60 ..... Thermostat Cover ..... T16-126

**19641** \_\_\_\_\_ **Duct - Transition**  
58-60 ..... Transition Duct..... n/a T2-106

**19833** \_\_\_\_\_ **Plate Assembly - Blower Mount**  
58-60 ..... Blower Motor Mount Plate..... T04-105  
58-60 ..... Blower Motor Mount Gasket ..... n/a

**19837** \_\_\_\_\_ **Hose - Inner Liquid Line**  
58-60 ..... Rear Liquid Hose, \* ..... T13-102  
\* *Requires core. / Between Sightglass & Expansion Valve*

**See Page 15 For More Information On How To Identify Internal & External Equalized Expansion Valves & Evaporators!**

**19849** \_\_\_\_\_ **Expansion Valve**  
58-66 ..... Expansion Valve, New Repl..... 15-101  
58-66 ..... Exp. Valve, Ext. Equalized\* ..... T15-101E  
58-66 ..... Exp. Valve, Int Equalized\* ..... T15-101I  
\* *Reconditioned - Core Charge, Add* ..... C-020

## Passenger Compartment

**19860** \_\_\_\_\_ **Coil Assembly - Evaporator**  
58-60 ..... Evaporator Ext. Eq.\* ..... T01-101E  
58-60 ..... Evaporator Int. Eq.\* ..... T01-101I  
58-60 ..... Evaporator, Ext. Eq., New ..... T01-102E  
58-60 ..... Evaporator, Int. Eq., New ..... T01-102I  
58-60 ..... Evap. Plenum Rebuild (lbr)+ ..... 17-TBEVU1  
\* *Outright Core Charge, Add* ..... C-050  
+ *Plus Parts & Repairs*

**CORE CHARGE**  
**Information**  
**See Page VI**

**19867** \_\_\_\_\_ **Hose - Suction**  
58-60 ..... Suction Hose..... T13-105

**19998** \_\_\_\_\_ **Evaporator Drain Hose**  
58-60 ..... Drain Tube ..... n/a

**19930** \_\_\_\_\_ **Blower Housing**  
58-60 ..... Blower Housing..... T04-103  
58-60 ..... Blower Housing Strap Set..... T04-104

**19A629** \_\_\_\_\_ **Housing - Evaporator Case**  
58-60 ..... Rear Plenum Housing\* ..... T01-110  
58-60 ..... Front Plenum Housing\* ..... T01-111  
58-60 ..... Access Panel ..... T01-112  
\* *Outright Core Charge, Add* ..... C-075

**19A634** \_\_\_\_\_ **Clamp - Bulb**  
58-66 ..... Bulb Clamp w/Hardware ..... 15-105

**19A706** \_\_\_\_\_ **Resistor - A/C Blower**  
58-60 ..... Blower Resistor..... T16-100

**19B552** \_\_\_\_\_ **Grommet - Case Housing**  
58-60 ..... Evaporator Fitting Grommet..... n/a

**CORE CHARGE**  
**Information**  
**See Page VI**

**Questions About Our Products, Installation, or Troubleshooting?**  
**Feel Free to Call our Knowledgeable Technical Staff**  
**They're Always Glad to Help!**

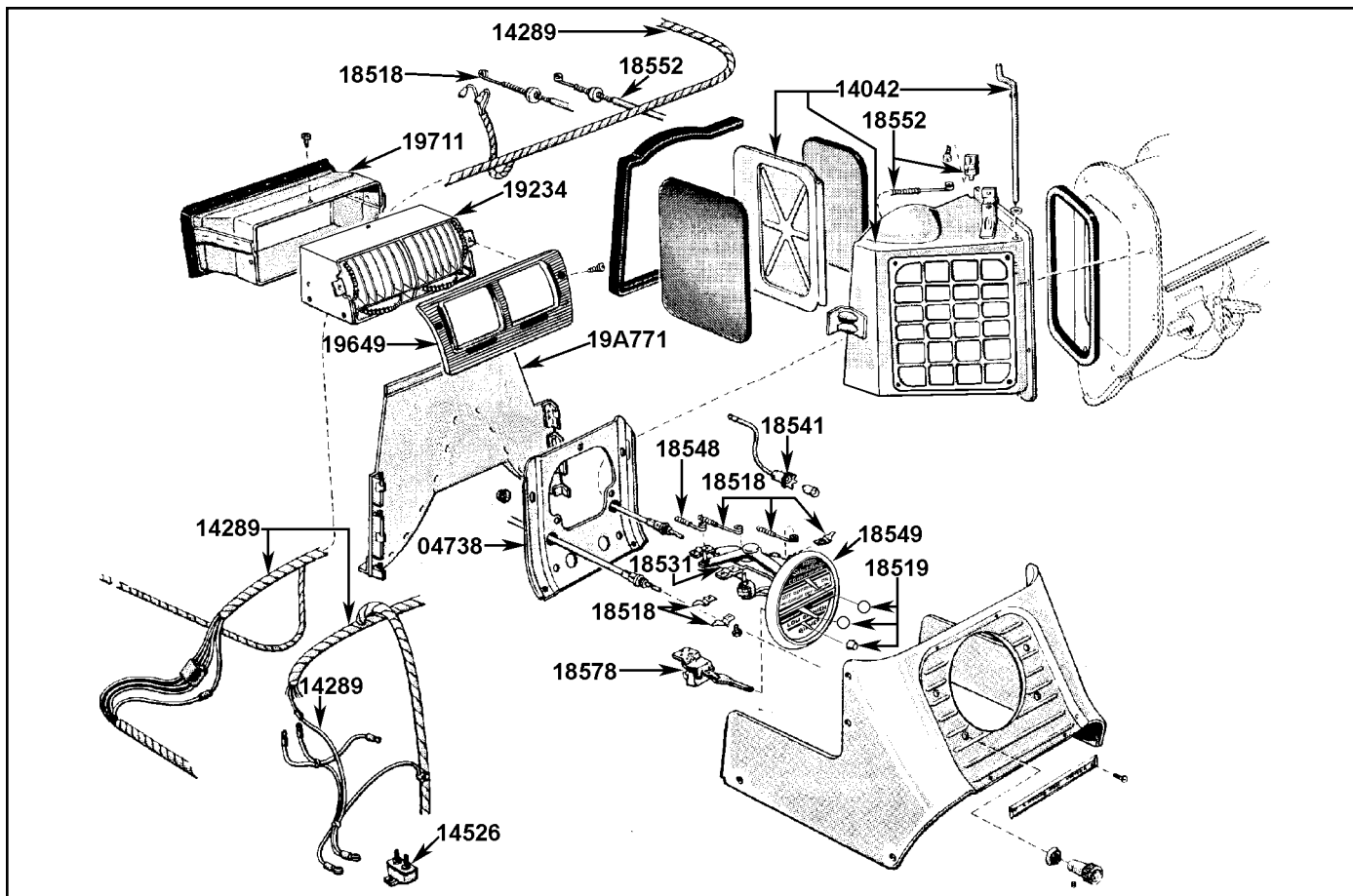
**1958 - 1960****Passenger Compartment**

**04738** \_\_\_\_\_ **Bracket - Control Panel**  
 58-60 ..... Control Panel Bracket..... T15-115

**14042** \_\_\_\_\_ **Air Inlet Assembly**  
 58-60 ..... Air Inlet Duct Assembly..... T02-107

**14289** \_\_\_\_\_ **Harness - A/C Wiring**  
 58-60 ..... Blower Wire Harness, New ..... n/a  
 58-60 ..... Clutch Wire, New ..... n/a

**14526** \_\_\_\_\_ **Circuit Breaker**  
 58-66 ..... Circuit Breaker, Replacement..... 16-119

**18518** \_\_\_\_\_ **Cable - Heat & Thermostat**  
 58-60 ..... Thermostat Cable, New ..... T16-102  
 58-60 ..... Heater Cable ..... T16-103  
 58-66 ..... Cable Clamp ..... 19-152

**18519** \_\_\_\_\_ **Knobs**  
 58-60 ..... Defrost/Air Knob, Used ..... T16-111  
 58-60 ..... Fan Knob, Used ..... T16-112

**18531** \_\_\_\_\_ **Control Lever Assembly**  
 58-60 ..... Control Lever Assembly..... 16-132

**18541** \_\_\_\_\_ **Bulb Socket Assembly**  
 58-60 ..... Socket & Harness ..... T16-127

**18548** \_\_\_\_\_ **Cable - Defrost**  
 58-60 ..... Defrost Cable, New ..... T16-106

**18549** \_\_\_\_\_ **Facia Panel**  
 58-60 ..... Facia Panel..... T02-122  
 58-66 ..... Control Head Reb (labor)\* ..... 17-CHM  
*\* Plus Parts*

**18552** \_\_\_\_\_ **Cable - Recirculate**  
 58..... Recirculate Cable, New ..... T16-104  
 59-60 ..... Recirculate Cable, New ..... T16-105  
 58-66 ..... Cable Clamp ..... 19-152

**18578** \_\_\_\_\_ **Switch - A/C Blower**  
 58-60 ..... Blower Switch, Recond..... T16-121

**19234** \_\_\_\_\_ **Louver Assembly**  
 58-60 ..... Center Louver ..... T02-101

**19649** \_\_\_\_\_ **Plate Assembly - Louver Trim**  
 58-60 ..... Louver Trim Panel..... T02-123

**19711** \_\_\_\_\_ **Connector - Center Louver**  
 58-60 ..... Center Louver Connector..... n/a T02-105

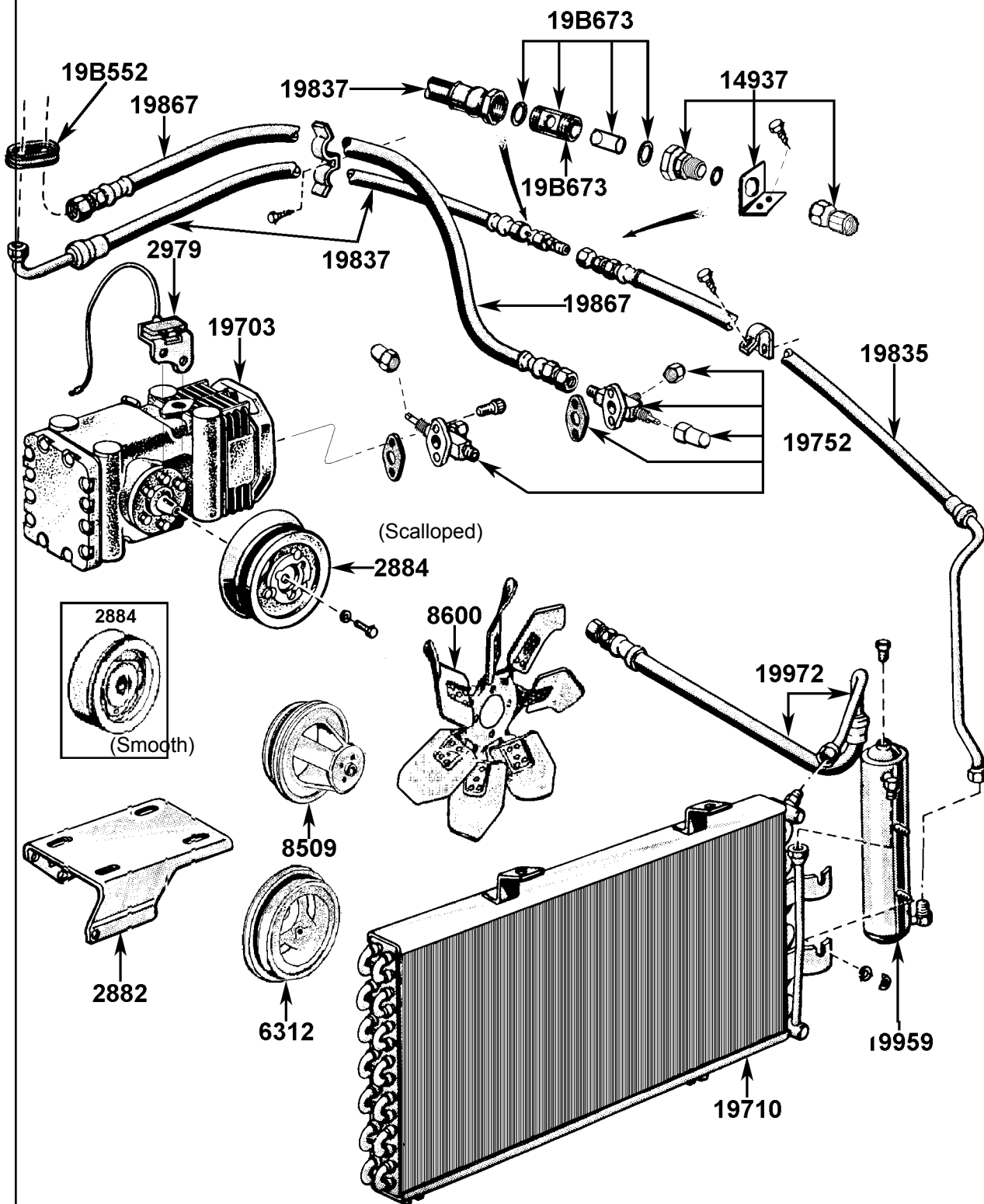
**1958 - 1960****Engine Compartment**



# 1958 - 1960

## 14937 Fitting - Quick Disconnect

58-60 .....	Quick Disconnect - Female.....	14-110
58-60 .....	Quick Disconnect - Male.....	14-111
58-60 .....	Quick Disconnect - M/F Assy. ....	14-112
58-60 .....	Quick Disconnect - Bracket.....	n/a

## 19703 Compressor Assembly

58-61 .....	Custom Comp. Rebuild.....	17-FYORK
58-61 .....	Finned York Flanged*.....	05-103F
58-60 .....	Sanden Conversion Kit R-12 .....	06-138T
58-60 .....	Sanden Conversion Kit 134a .....	06-141T
* Outright Core Charge, Add .....		C-FY

**See Page 19 For Information  
On Our Sanden Compressor  
Conversion Kits!**

## 19710 Coil Assembly - Condenser

58-60 .....	Condenser, Reconditioned*.....	11-107R
58-60 .....	Condenser, New .....	11-107
* Outright Core Charge, Add .....		C-250

## 19752 Compressor Service Valve, Caps & Seals

58-61 .....	Dis. Service Valve .....	14-115
58-61 .....	Suct. Service Valve .....	14-116
58-61 .....	Dis. Service Valve, .....	14-115R
58-61 .....	Suct. Service Valve, Repl.....	14-116R
58-61 .....	Flange Gasket, New, each.....	14-117
58-61 .....	Steel Bullet Cap, each .....	14-107S
62-66 .....	Bullet Cap Set, New, pair* .....	14-107
58-66 .....	Brass Serv. Port Cap, New, ea. ....	14-108
* Will Also Fit 58-61.		

## 19835 Hose - Outer Liquid Line

58-60 .....	Front Liquid Hose.....	T13-101
<i>Between Barrel Sightglass &amp; Filter-Drier</i>		

## 19837 Hose - Inner Liquid Line

58-60 .....	Rear Liquid Line.....	T13-102
* Outright Core Charge, Add .....		C-050
<i>Between Sightglass &amp; Expansion Valve</i>		

## 19867 Suction Hose

58-60 .....	Suction Hose, New .....	T13-105
-------------	-------------------------	---------

## 19959 Filter/Drier

58-60 .....	Filter Drier*.....	T12-106
* Outright Core Charge, Add .....		C-050

## 19972 Discharge Hose

58-60 .....	Discharge Hose, New .....	T13-108
-------------	---------------------------	---------

## 19B552 Grommet - Case Housing

58-60 .....	Evaporator Fitting Grommet.....	n/a
-------------	---------------------------------	-----

# Engine Compartment

**Be Sure To Read The  
Ordering & Policy Section  
Carefully!  
(Pgs. III - V)**

## 19B673 Barrel Sightglass

58-64 .....	Barrel Sightglass* .....	13-400
58-64 .....	Copper Washers, New, each .....	13-403
58-64 .....	Glass Insert.....	13-402
58-64 .....	Male Quick-Disconnect Port .....	14-121
58-64 .....	Sightglass Rebuild Kit+ .....	13-401
* Outright Core Charge, Add .....		C-BSG
+ Includes Glass Insert, O-Rings & Copper Washers		

## 2882 Compressor Mounting Bracket

58-60 .....	Y-Block Compressor Mount .....	07-101Y
58-60 .....	FE Compressor Mount.....	07-101F

## 2884 Compressor Clutch & Pulley Assembly

58-60 .....	Y-Block Smooth Comp. Clutch+ .....	08-121
58-60 .....	Y-Block Scalloped Comp. Clutch* .....	08-122
58-60 .....	FE Comp Clutch w/Coil^ .....	08-123
58-60 .....	Clutch Bearing, New .....	08-108
* Outright Core Charge, Add .....		C-250
+ Outright Core Charge, Add .....		C-150
^ Outright Core Charge, Add .....		C-050

## 2979 Brush Set - Compressor Clutch

58-63 .....	Clutch Brush Set.....	08-120
* Outright Core Charge, Add .....		C-HACB

## 6312 Pulley - Crankshaft with A/C

58-60 .....	Crank Pulley (Y-Block) .....	07-111F
58-60 .....	Crank Pulley (FE).....	07-112F

## 8509 Pulley - Waterpump

58-60 .....	Waterpump Pulley (Y-Block) .....	07-115F
58-60 .....	Waterpump Pulley (FE).....	07-116F

## 8600 Fan - Engine Cooling

58-60 .....	Engine Fan (Y-Block) .....	T09-109
58-60 .....	Engine Fan (FE).....	T09-110
17" 6-Blade Engine Fan .....		9-113
18" 6-Blade Engine Fan .....		09-114

**CORE CHARGE  
Information  
See Page VI**

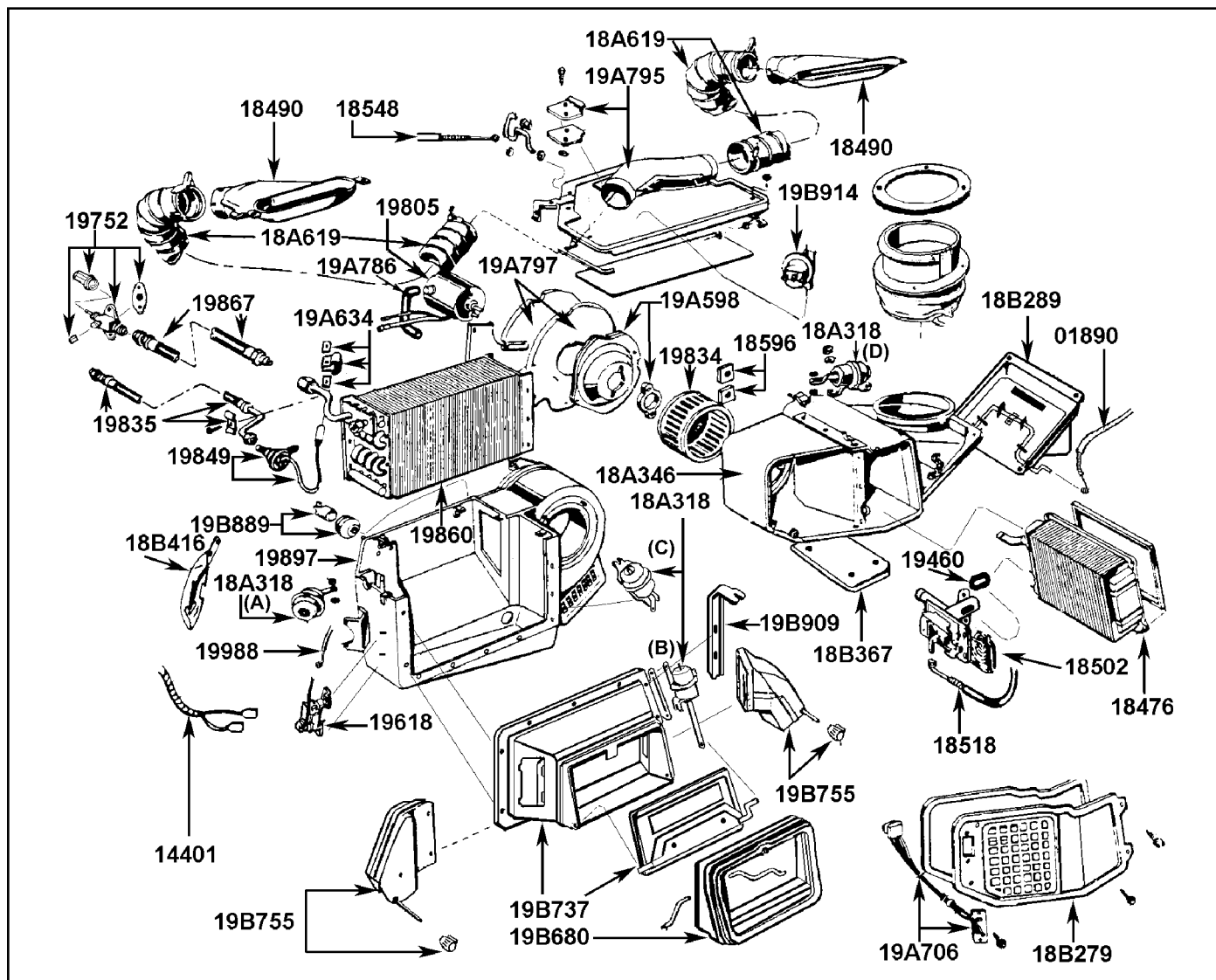

**1961 - 1963****Passenger Compartment**

**01890 Cable - Recirculate**  
 61-3 ..... Recirculate Cable w/Knob..... T16-107

**14401 Harness - A/C Wiring**  
 61..... Blower Wire Harness, New ..... n/a  
 62-3 ..... Blower Wire Harness, New ..... n/a

**18476 Heater Coil**  
 61-63 ..... Heater Coil\*..... T18-101  
 61-66 ..... Heater Plenum Rebuild (lbr)+ ..... 17-TBHU  
 \*Outright Core Charge - Add ..... C-040  
 + Plus Parts & Repairs

**18490 Duct - LH/RH Defrost**  
 61-66 ..... LH Defrost Duct ..... T02-108  
 61-66 ..... RH Defrost Duct..... T02-109

**18502 Valve - Heater Water Control**  
 61-63 ..... Heater Valve Rebuild (lbr) \* ..... 17-HWV  
 \* Customer must supply rebuildable core w/good neck.

**18518 Cable - Heater**  
 61-63 ..... Heater Cable\* ..... T16-108  
 \*Outright Core Charge - Add ..... C-030

**18548 Cable - Defrost**  
 61-63 ..... Defrost Cable, New ..... T16-109

**18A318 Vacuum Motor**  
 61-66 ..... LH Heat Vac. Mtr. (A)..... 03-104  
 61-66 ..... Air Shutter Door Vac. Mtr. (B) ..... T03-102  
 61-66 ..... RH Heat Vac. Mtr. (C) ..... T03-103  
 61-66 ..... Recirculate Vac. Mtr. (D) ..... T03-104  
 61-66 ..... Repl. Vacuum Motor, New\* ..... 03-122  
 \*Replaces All 61-66 A, B & D.

**18A346 Case Assembly - Heater**  
 61-63 ..... Heater Case ..... T1-116  
 \*Outright Core Charge - Add ..... C-075



# 1961 - 1963

**18A619 Connector - Defrost Flex**

61-66 ..... LH/RH Defrost Flex Hose..... T02-110  
 61-66 ..... 2 1/2" Universal Flex Hose, ft. .... 02-1014

**18B279 Cover - Heater Case**

61-66 ..... Heater Case Cover ..... T01-121

**18B289 Air Inlet Assembly - Heater**

61-63 ..... Air Inlet Duct Assembly ..... T02-117  
 61-63 ..... Plastic Air Inlet Cover ..... T02-118

**18B367 Panel - Heater Valve Access**

61-63 ..... Heater Valve Access Panel ..... T01-117

**18B416 Deflector - Air Outlet**

61-66 ..... Air Deflector ..... T02-124

**19460 Seal - Heater Water Valve To Heater Core**

61-63 ..... Heater Valve- Core Seal ..... T18-103

**19618 Switch - Thermostat**

58-63 ..... Thermostat Body, New ..... T16-118  
 61-63 ..... Thermostat Mount ..... T16-125

**19752 Compressor Service Valve, Caps & Seals**

58-61 ..... Dis. Service Valve ..... 14-115  
 58-61 ..... Suct. Service Valve ..... 14-116  
 58-61 ..... Dis. Service Valve, ..... 14-115R  
 58-61 ..... Suct. Service Valve, Repl. .... 14-116R  
 58-61 ..... Flange Gasket, New, each ..... 14-117  
 58-61 ..... Steel Bullet Cap, each ..... 14-107S  
 58-66 ..... Brass Service Port Cap, New ..... 14-108  
 62-66 ..... Discharge Service Valve ..... 14-101  
 62-66 ..... Suction Service Valve ..... 14-102  
 62-66 ..... Rotolock Seal ..... 14-113  
 62-66 ..... Bullet Cap Set, New, pair\* ..... 14-107

\* Will Also Fit 58-61.

**19805 Motor - A/C Blower**

61-63 ..... Blower Motor, Recond.\* ..... T04-108  
 \*Outright Core Charge - Add ..... C-050

**19834 Blower Wheel**

61-66 ..... Blower Wheel ..... T04-102

**19835 Liquid Line - Hose Assembly**

61-64 ..... Liquid Hose ..... T13-103  
 61-66 ..... Liquid Hose Clamp ..... T18-104

**19849 Expansion Valve**

58-66 ..... Expansion Valve, New Repl. .... 15-101  
 58-66 ..... Exp. Valve, Ext. Equalized\* ..... T15-101E  
 58-66 ..... Exp. Valve, Int Equalized ..... T15-101I  
 \* Reconditioned - Core Charge, Add ..... C-020

**See Page 15 For More Information On How To Identify Internal & External Equalized Expansion Valves & Evaporators!**

# Passenger Compartment

**19860 Coil Assembly - Evaporator**

61-66 ..... Evaporator Ext. Eq.\* ..... T01-103E  
 61-66 ..... Evaporator Int. Eq.\* ..... T01-103I  
 61-66 ..... Evaporator, Ext. Eq., New ..... T01-104E  
 61-66 ..... Evaporator, Int. Eq., New ..... T01-104I  
 61-63 ..... Evap. Plenum Reb (labor)+ ..... 17-TBEVU2  
 \* Outright Core Charge, Add ..... C-050  
 + Plus Parts & Repairs

**19867 Suction Hose**

61-63 ..... Suction Hose ..... T13-106

**19897 Case Assembly - A/C Evaporator**

61-63 ..... Evaporator Case\* ..... T01-113  
 \* Outright Core Charge, Add ..... C-075

**19988 Cable - Thermostat**

61-63 ..... Thermostat Cable, New ..... T16-110

**19A598 Plate Assembly - Blower Motor Mount**

61-66 ..... Blower Motor Mount Plate ..... T04-106  
 61-66 ..... Blower Motor Mount Gasket ..... n/a

**19A634 Clamp - Bulb**

58-66 ..... Bulb Clamp w/Hardware ..... 15-105

**19A706 Resistor - A/C Blower Motor**

61-66 ..... Blower Resistor ..... T16-101

**19A786 Tube - Blower/Motor**

61-66 ..... Blower Motor Vent Tube ..... n/a

**19A795 Cover Assembly - Evaporator**

61-63 ..... Evaporator Cover, Top ..... T01-114  
 61-63 ..... Defrost Cable Access Cover ..... T01-115

**19A797 Seal & Cover**

61-66 ..... F/W Blower Motor Grommet ..... T19-101  
 61-66 ..... F/W Blower Motor Bracket ..... T19-102

**19B680 Connector To Bezel**

61-63 ..... Center Louver Connector.... T2-111 n/a

**19B737 Duct - Evaporator Case To Connector**

61-63 ..... Center Duct w/Deflector ..... T02-113

**19B755 Outlet - Floor Duct**

61-63 ..... LH Floor Duct Outlet ..... T02-115  
 61-63 ..... RH Floor Duct Outlet ..... T02-116  
 61-63 ..... LH/RH Floor Duct Knob, ea ..... T16-114

**19B889 Seal - Inner Drain Tube**

61-66 ..... Inner Drain Tube Seal ..... n/a  
 61-66 ..... Drain Tube ..... n/a

**19B909 Bracket - Case Support**

61-63 ..... Case Support Bracket, Front ..... T19-103

**19B914 Switch Assembly - Blower Motor Ground**

62-63 ..... Ground Switch Assembly ..... T16-128

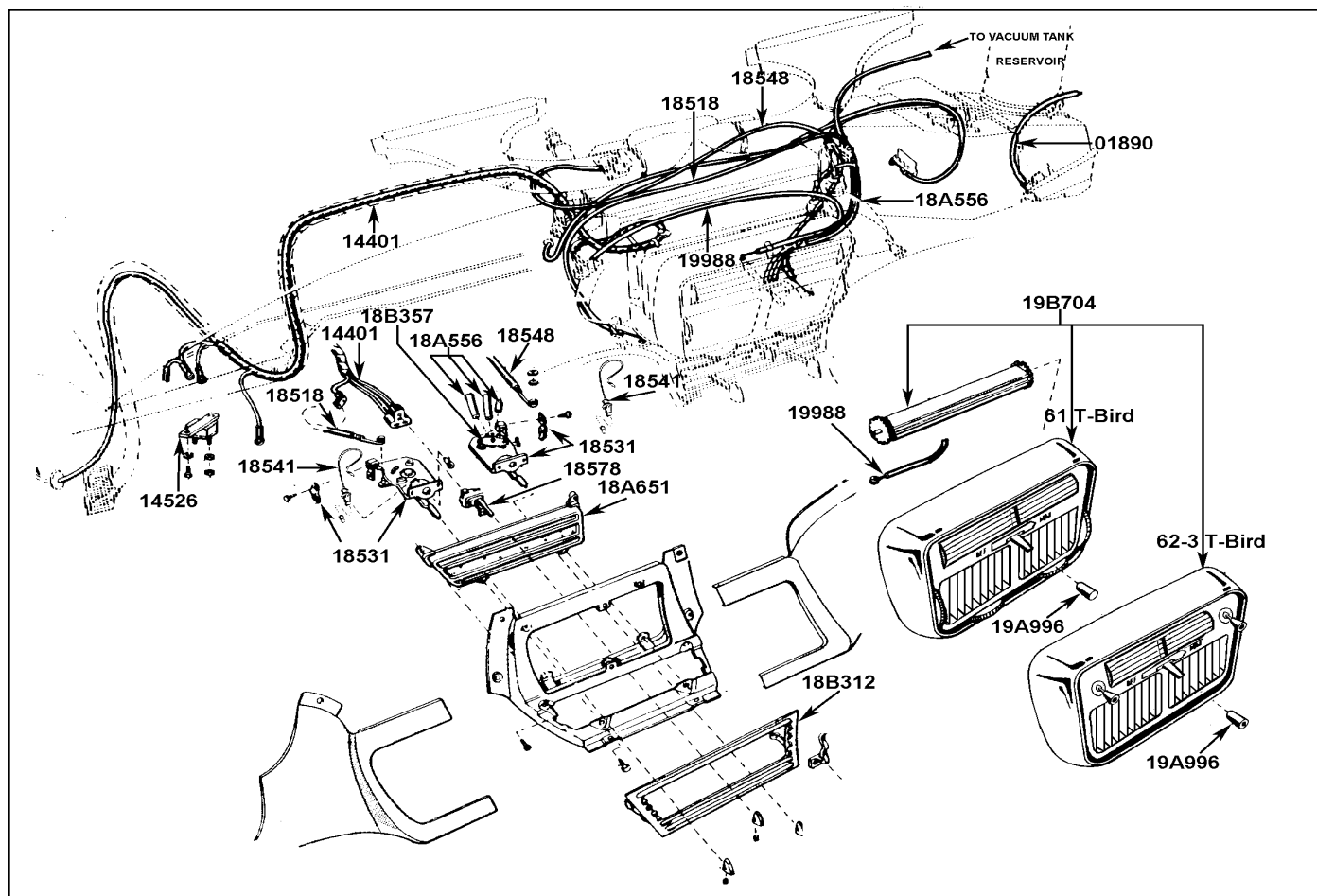
**1961 - 1963****Passenger Compartment****01890 Cable - Recirculate**

61-63 ..... Recirculate Cable w/Knob..... T16-107

**14401 Harness - A/C Wiring**

61..... Blower Wire Harness, New ..... n/a

62-63 ..... Blower Wire Harness, New ..... n/a

**14526 Circuit Breaker**

58-66 ..... Circuit Breaker, Replacement ..... 16-119

**18518 Cable - Heater**

61-63 ..... Heater Cable\* ..... T16-108

\*Outright Core Charge - Add ..... C-030

**18531 Control Lever Assembly**

61-63 ..... LH Control Lever Assy ..... T16-129

61-63 ..... RH Control Lever Assy ..... T16-130

58-66 ..... Cable Clamp ..... 19-152

**18541 Bulb Socket Assembly**

61-66 ..... Socket &amp; Harness Wire..... T16-131

**18548 Cable - Defrost**

61-63 ..... Defrost Cable, New..... T16-109

**18578 Switch - A/C Blower**

61-63 ..... Blower Switch, Recond ..... T16-122

**18A651 Facia Panel**

61-63 ..... Facia Panel ..... T02-125

58-66 ..... Control Head Reb (labor)\* ..... 17-CHM

\* Plus Parts

**18A556 Vacuum Hose Set**

61-63 ..... Vacuum Hose Set, New ..... T03-105

**18B312 Plate Assembly - Control Head Trim**

61-63 ..... Control Head Trim Panel..... T03-105

**18B357 Vacuum Switch Assembly**

61-63 ..... Rotary Vacuum Switch..... T03-109

\*Outright Core Charge - Add ..... C-020

**19988 Cable - Thermostat**

61-63 ..... Thermostat Cable, New ..... T16-110

**19A996 Knob - Thermostat**

61..... Temp. Lever Knob, Used ..... T16-113

62-63 ..... Temp. Lever Knob, Used ..... T16-114

**19B704 Louver Assembly**

61..... Center Louver ..... T02-102

62-63 ..... Center Louver ..... T02-103

## 1961 - 1963

## Engine Compartment

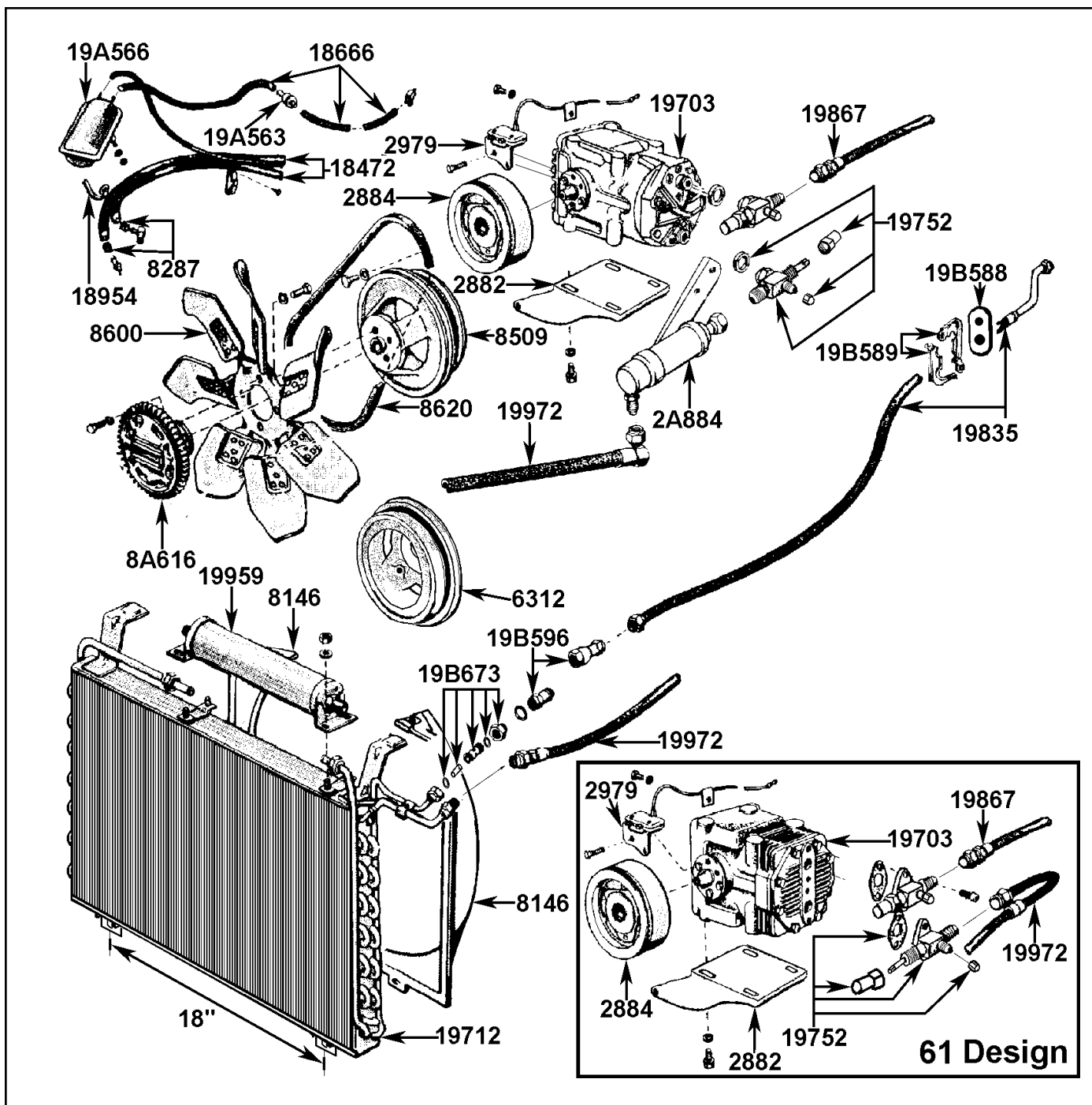

**18472** \_\_\_\_\_ **Hose - Heater**  
 Heater Hose, 5/8" ID\* ..... 18-107  
*\* Priced Per Foot*

**18666** \_\_\_\_\_ **Vacuum Hose Set**  
 61-63 ..... Vacuum Hose Set, New ..... T03-105

**See Page 19 For  
 Information On Our Sanden  
 Compressor Conversion Kits!**

**19703** \_\_\_\_\_ **Compressor Assembly**  
 58-61 ..... Custom Comp. Rebuild\* ..... 17-FYORK  
 62-63 ..... Custom Comp. Rebuild+ ..... 17-SYORK  
 58-61 ..... Finned York Flanged\* ..... 05-103F  
 62-63 ..... Smooth York Roto\* ..... 05-103S  
 61-65 ..... Sanden Conversion Kit R-12 ..... 06-139T  
 61-65 ..... Sanden Conversion Kit 134a ..... 06-142T  
 \* Outright Core Charge, Add ..... C-FY  
 + Outright Core Charge, Add ..... C-SY

# 1961 - 1963

# Engine Compartment

## 19712 \_\_\_\_\_ Coil Assembly - Condenser

61-63 ..... Condenser, Recond.\* ..... 11-108R  
 61-63 ..... Condenser, New ..... 11-108  
 \* *Outright Core Charge, Add* ..... C-150

## 19752 \_\_\_\_\_ Compressor Service Valve, Caps & Seals

58-61 ..... Dis. Service Valve ..... 14-115  
 58-61 ..... Suct. Service Valve ..... 14-116  
 58-61 ..... Dis. Service Valve, ..... 14-115R  
 58-61 ..... Suct. Service Valve, Repl. .... 14-116R  
 58-61 ..... Flange Gasket, New, each ..... 14-117  
 58-61 ..... Steel Bullet Cap, each ..... 14-107S  
 62-66 ..... Bullet Cap Set, New, pair\* ..... 14-107  
 58-66 ..... Brass Serv. Port Cap, New, ea. .... 14-108  
 62-66 ..... Discharge Service Valve, New ..... 14-101  
 64-66 ..... Suction Service Valve, New ..... 14-102  
 62-66 ..... Rotolock Seal, New ..... 14-113

\* *Will Also Fit 58-61.*

+ *Two Required; Suction/Discharge Are The Same.*

## 19835 \_\_\_\_\_ Liquid Line - Hose Assembly

61-64 ..... Liquid Hose, New ..... T13-103  
 61-66 ..... Liquid Hose Clamp ..... T18-104

## 19867 \_\_\_\_\_ Suction Hose

61-63 ..... Suction Hose, New ..... T13-106

## 19959 \_\_\_\_\_ Filter/Drier

61-65 ..... Filter Drier\* ..... T12-107  
 \* *Outright Core Charge, Add* ..... C-050

## 19972 \_\_\_\_\_ Discharge Hose

61 ..... Discharge Hose, New ..... T13-109  
 62-63 ..... Discharge Hose, New ..... T13-110

## 19A563 \_\_\_\_\_ Vacuum Check Valve

61-66 ..... Vacuum Check Valve, New ..... 03-114

## 19A566 \_\_\_\_\_ Vacuum Tank & Bracket

61-63 ..... Vacuum Canister ..... T03-107

## 19B588 \_\_\_\_\_ Grommet - Firewall

61-66 ..... Firewall Hose Grommet ..... 19-104  
 61-66 ..... F/W Blow Mtr Grommet ..... T19-101

## 19B589 \_\_\_\_\_ Bracket - Firewall

61-66 ..... Firewall Hose Bracket ..... 19-109  
 61-66 ..... F/W Bracket & Grommet Set ..... 19-110  
 61-66 ..... F/W Blower Mtr Bracket ..... T19-102

## 19B596 \_\_\_\_\_ Fitting - Quick Disconnect

61-66 ..... Quick Disconnect F, ..... 14-110  
 61-66 ..... Quick Disconnect M, ..... 14-111  
 61-66 ..... Quick Disconnect M/F ..... 14-112  
 58-64 ..... Male Quick-Disconnect Port ..... 14-121

## 19B673 \_\_\_\_\_ Barrel Sightglass

58-64 ..... Barrel Sightglass\* ..... 13-400  
 58-64 ..... Copper Washers, New, ea ..... 13-403  
 58-64 ..... Glass Insert ..... 13-402  
 58-64 ..... Male Quick-Disconnect Port ..... 14-121  
 58-64 ..... Sightglass Rebuild Kit+ ..... 13-401  
 \* *Outright Core Charge, Add* ..... C-BSG  
 + *Includes Glass Insert, O-Rings & Copper Washers*

## 2882 \_\_\_\_\_ Compressor Mounting Bracket

61-63 ..... Compressor Mount ..... 07-102F

## 2884 \_\_\_\_\_ Compressor Clutch & Pulley Assembly

61-64 ..... Compressor Clutch FE \* ..... 08-119  
 58-66 ..... Clutch Bearing, New ..... 08-108  
 \* *Outright Core Charge, Add* ..... C-050

## 2979 \_\_\_\_\_ Brush Set - Compressor Clutch

58-63 ..... Clutch Brush Set ..... 08-120  
 \* *Outright Core Charge, Add* ..... C-HACB

## 2A884 \_\_\_\_\_ Muffler - Discharge

62-63 ..... Discharge Muffler ..... 13-110B

## 6312 \_\_\_\_\_ Pulley - Crankshaft with A/C

61-63 ..... Crank Pulley ..... 07-113F

## 8146 \_\_\_\_\_ Fan Shroud

61-63 ..... Fan Shroud LH ..... T09-101  
 61-63 ..... Fan Shroud RH ..... T09-102  
 61-63 ..... Fan Shroud LH/RH ..... T09-103

## 8287 \_\_\_\_\_ Hose Clamp - Heater Hose

59-66 ..... Heater Hose Clamp ..... 18-109

## 8509 \_\_\_\_\_ Pulley - Waterpump

61-63 ..... Waterpump Pulley ..... 07-117F

## 8600 \_\_\_\_\_ Fan - Engine Cooling

61-63 ..... Engine Fan ..... T09-111  
 17" 6-Blade Engine Fan ..... 09-113  
 18" 6-Blade Engine Fan ..... 09-114

## 8A616 \_\_\_\_\_ Clutch - Engine Fan

61-66 ..... Fan Clutch ..... n/a

**Have You Read the A/C Basics &  
 Helpful Tips Sections?  
 See Pages II and III**

## 1964-1966

## Passenger Compartment

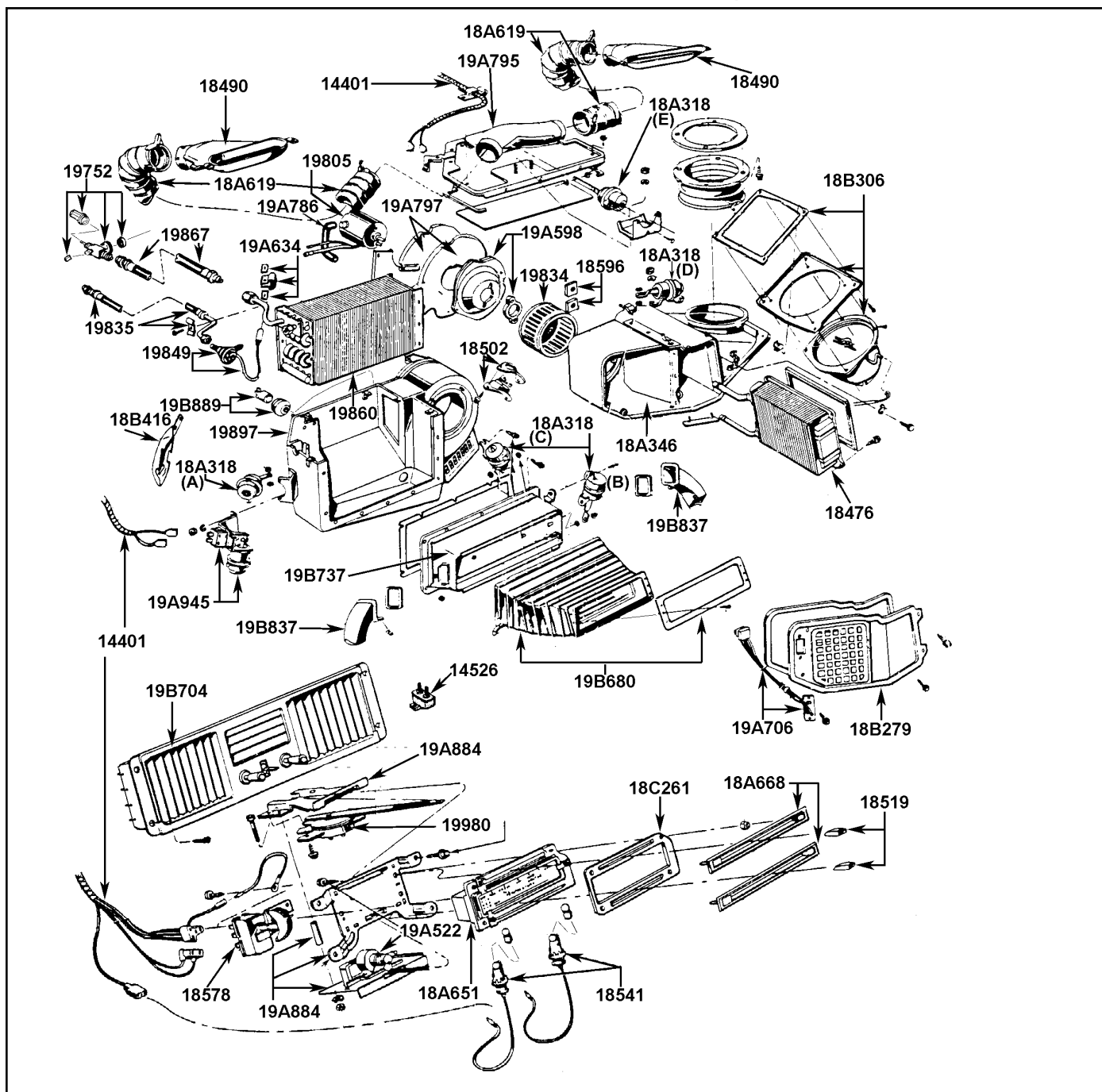

<b>14401</b>	<b>Harness - A/C Wiring</b>
64-66 .....	Blower Wire Harness, New ..... n/a

**14526 \_\_\_\_\_ Circuit Breaker**  
58-66 ..... Circuit Breaker, Replacement ..... 16-119

<b>18476</b>	<b>Heater Coil</b>
64-66 .....	Heater Coil*..... T18-102
61-66 .....	Heater Plenum Rebuild (lbr)+ ..... 17-TBHU
*Outright Core Charge - Add .....C-040	
+ Plus Heater Valve Rebuild, Repairs & Heater Core.	

**8490** \_\_\_\_\_ **Duct - LH/RH Defrost**  
61-66 .... LH Defrost Duct ..... T02-108  
61-66 .... RH Defrost Duct ..... T02-109

**18502\_\_\_ Valve - Heater Temperature Regulator**  
 64-66 ..... Heater Temp. Regulator ..... T16-133  
 \*Outright Core Charge - Add ..... C-030

**18519** \_\_\_\_\_ **Knobs**  
64-66 ..... Control Head Knobs, Used ..... T16-116



# 1964-1966

**18541** \_\_\_\_\_ **Bulb Socket Assembly**  
61-66 ..... Socket & Harness Wire ..... T16-131

**18578** \_\_\_\_\_ **Switch - A/C Blower**  
64-66 ..... Blower Switch, Recond. .... T16-123

**18596** \_\_\_\_\_ **Gasket - Heater Inlet**  
61-66 ..... Heater Tube Gasket, pair ..... n/a

**18A318** \_\_\_\_\_ **Vacuum Motor**  
61-66 ..... LH Heat Vac. Mtr. (A) ..... 03-104  
61-66 ..... Air Shutter Door Vac. Mtr. (B) ..... T03-102  
61-66 ..... RH Heat Vac. Mtr. (C) ..... T03-103  
61-66 ..... Recirculate Vac. Mtr. (D) ..... T03-104  
61-66 ..... Repl. Vacuum Motor, New\* ..... 03-122  
*\*Replaces All 61-66 A, B & D.*

**18A346** \_\_\_\_\_ **Case Assembly - Heater**  
64-66 ..... Heater Case ..... T01-120  
*\*Outright Core Charge - Add ..... C-040*

**18A619** \_\_\_\_\_ **Connector - Defrost Flex**  
61-66 ..... LH/RH Defrost Flex Hose ..... T02-110  
61-66 ..... 2 1/2" Universal Flex Hose, ft. .... 02-1014

**18A651** \_\_\_\_\_ **Facia Panel**  
64-66 ..... Facia Panel ..... T02-126  
58-66 ..... Control Head Reb (labor)\* ..... 17-CHM  
*\* Plus Parts*

**18B279** \_\_\_\_\_ **Cover - Heater**  
61-66 ..... Heater Case Cover ..... T01-121

**18B306** \_\_\_\_\_ **Air Inlet Assembly - Heater**  
64-66 ..... Air Inlet Duct Assembly ..... T02-119

**18B416** \_\_\_\_\_ **Deflector - Air Outlet**  
61-66 ..... Air Deflector ..... T02-124

**19752** \_\_\_\_\_ **Compressor Service Valve, Caps & Seals**  
62-66 ..... Discharge Service Valve ..... 14-101  
62-66 ..... Suction Service Valve ..... 14-102  
62-66 ..... Rotolock Seal ..... 14-113  
62-66 ..... Bullet Cap Set, New, pair\* ..... 14-107  
58-66 ..... Brass Service Port Cap, New ..... 14-108

**19805** \_\_\_\_\_ **Motor - A/C Blower**  
64-66 ..... Blower Motor, Recond.\* ..... T04-110  
*\*Outright Core Charge - Add ..... C-050*

**19834** \_\_\_\_\_ **Blower Wheel**  
61-66 ..... Blower Wheel ..... T04-102

**19835** \_\_\_\_\_ **Liquid Line - Hose Assembly**  
61-64 ..... Liquid Line ..... T13-103  
65-66 ..... Liquid Line ..... T13-104  
61-66 ..... Liquid Hose Clamp ..... T18-104

# Passenger Compartment

**19849** \_\_\_\_\_ **Expansion Valve**  
58-66 ..... Expansion Valve, New Repl. .... 15-101  
58-66 ..... Exp. Valve, Ext. Equalized\* ..... T15-101E  
58-66 ..... Exp. Valve, Int Equalized\* ..... T15-101I  
*\* Reconditioned - Core Charge, Add ..... C-020*

**See Page 15 For How To Identify Internally  
& Externally Equalized Expansion Valves & Evaporators!**

**19860** \_\_\_\_\_ **Coil Assembly - Evaporator**  
61-66 ..... Evaporator Ext. Eq.\* ..... T01-103E  
61-66 ..... Evaporator Int. Eq.\* ..... T01-103I  
61-66 ..... Evaporator, Ext. Eq., New ..... T01-104E  
61-66 ..... Evaporator, Int. Eq., New ..... T01-104I  
64-66 ..... Evap. Plenum Rebuild (lbr)+ ..... 17-TBEVU3  
*\* Outright Core Charge, Add ..... C-050  
+ Plus Parts & Repairs*

**19897** \_\_\_\_\_ **Case Assembly - A/C Evaporator**  
64-66 ..... Evaporator Case\* ..... T01-118  
*\* Outright Core Charge, Add ..... C-040*

**19980** \_\_\_\_\_ **Vacuum Switch Assembly**  
64-66 ..... Rotary Vacuum Switch\* ..... T03-110  
*\* Outright Core Charge, Add ..... C-020*

**19A522** \_\_\_\_\_ **Switch - Temperature Regulator**  
64-66 ..... Control Temp. Regulator\* ..... T16-134  
*\* Outright Core Charge, Add ..... C-030*

**19A706** \_\_\_\_\_ **Resistor - A/C Blower Motor**  
61-66 ..... Blower Resistor ..... T16-101

**19A795** \_\_\_\_\_ **Cover Assembly - Evaporator**  
64-66 ..... Evaporator Cover, Top ..... T01-119

**19A945** \_\_\_\_\_ **Switch - Thermostat/Vacuum Motor Assy**  
64-66 ..... Vacuum/Thermostat Assy\* ..... T16-120  
64-66 ..... Thermostat Body\* ..... T16-119  
64-66 ..... Thermostat Vacuum Motor ..... T03-101  
*\*Outright Core Charge - Add ..... C-050*

**19B680** \_\_\_\_\_ **Connector To Bezel**  
64-66 ..... Center Louver Connector ..... T02-112

**19B704** \_\_\_\_\_ **Louver Assembly**  
64-66 ..... Center Louver ..... T02-104

**19B737** \_\_\_\_\_ **Duct - Evaporator Case To Connector**  
64-66 ..... Center Duct w/Deflector ..... T02-114

**19B837** \_\_\_\_\_ **Outlet - Floor Duct**  
64-66 ..... LH Floor Duct ..... T02-120  
64-66 ..... RH Floor Duct ..... T02-121

# 1964-1966

# Engine Compartment

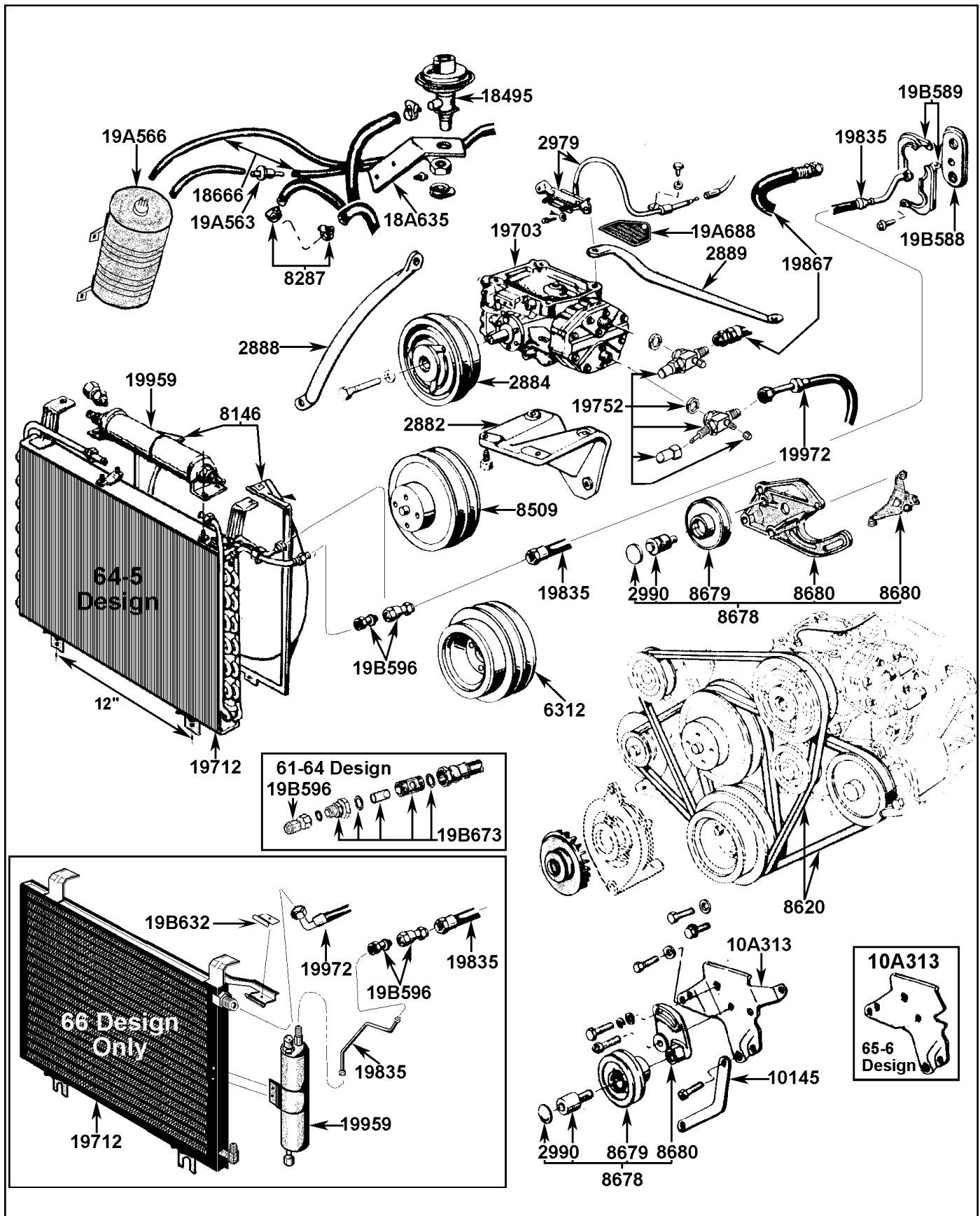

# 1964-1966

**10145** **Arm - Alternator Adjustment**  
64-66 ..... Alternator Adjustment Arm ..... T07-101

**10A313** **Bracket - Idler/Alternator**  
64 ..... Idler/Generator Bracket ..... 07-143F  
65-66 ..... Idler/Alternator Bracket ..... 07-144F

**18472** **Hose - Heater**  
Heater Hose, 5/8" ID\* ..... 18-107  
*\* Priced Per Foot*

**18495** **Valve - Heater Water Control**  
64-66 ..... Heater Water Valve, Repl. .... 18-H977

**18666** **Vacuum Hose Set**  
64-66 ..... Vacuum Hose Set, Orig. .... T03-106

**18A635** **Bracket - Water Control**  
64-66 ..... Water Valve Bracket ..... n/a

**19703** **Compressor Assembly**  
64-66 ..... Custom York Compressor Rebuild ..... 17-YORK  
64-66 ..... Custom Tecumseh Comp. Rebuild ..... 17-TEC  
64-66 ..... Tecumseh Roto ..... 05-101  
64-66 ..... York Roto, New ..... 05-105  
64-66 ..... York Roto, Rebuilt ..... 05-103  
61-65 ..... Sanden Conversion Kit R-12 ..... 06-139T  
61-65 ..... Sanden Conversion Kit 134a ..... 06-142T  
66 ..... Sanden Conversion Kit R-12 ..... 06-140T  
66 ..... Sanden Conversion Kit 134a ..... 06-143T

**See Page 19 For Information  
On Our Sanden Compressor  
Conversion Kits!**

**19712** **Coil Assembly - Condenser**  
64 ..... Condenser, Reconditioned\* ..... 11-109R  
64 ..... Condenser, New ..... 11-109  
65 ..... Condenser, Reconditioned\* ..... 11-110R  
65 ..... Condenser, New ..... 11-110  
66 ..... Condenser, Reconditioned\* ..... 11-111R  
66 ..... Condenser, New ..... 11-111  
*\* Outright Core Charge, Add ..... C-150*

**19752** **Compressor Service Valve, Caps & Seals**  
58-66 ..... Brass Service Port Cap, New ..... 14-108  
62-66 ..... Discharge Service Valve, New ..... 14-101  
62-66 ..... Suction Service Valve, New ..... 14-102  
62-66 ..... Rotolock Seal, New ..... 14-113  
62-66 ..... Bullet Cap Set, New, pair\* ..... 14-107  
58-66 ..... Brass Serv. Port Cap, New, ea. .... 14-108  
*\* Will Also Fit 58-61.*

# Engine Compartment

**19835** **Liquid Line - Hose Assembly**  
61-64 ..... Liquid Hose ..... T13-103  
65-66 ..... Liquid Hose ..... T13-104  
61-66 ..... Liquid Hose Clamp ..... T18-104  
66 ..... Liquid Line ..... T13-113

**19867** **Suction Hose**  
61-63 ..... Suction Hose, New ..... T13-106  
64-66 ..... Suction Hose, New ..... T13-107

**19959** **Filter/Drier**  
61-65 ..... Filter Drier\* ..... T12-107  
66 ..... Filter Drier\* ..... T12-108  
*\* Outright Core Charge, Add ..... C-050*

**19972** **Discharge Hose**  
64-65 ..... Discharge Hose, New ..... T13-111  
66 ..... Discharge Hose, New ..... T13-112

**19A563** **Vacuum Check Valve**  
61-66 ..... Vacuum Check Valve, New ..... 03-114

**19A566** **Vacuum Tank & Bracket**  
64-66 ..... Vacuum Canister ..... T03-108

**19A688** **Service Tag**  
Ford A/C Service Tag, New ..... 05-111

**19B588** **Grommet - Firewall**  
61-66 ..... Firewall Hose Grommet ..... 19-104

**19B589** **Bracket - Firewall**  
61-66 ..... Firewall Hose Bracket ..... 19-109  
61-66 ..... F/W Bracket & Grommet Set ..... 19-110

**19B596** **Fitting - Quick Disconnect**  
61-66 ..... Quick Disconnect Female, New ..... 14-110  
61-66 ..... Quick Disconnect Male, New ..... 14-111  
61-66 ..... Quick Disconnect M/F Assy, ..... 14-112

**19B632** **Clamp - Tube Support**  
66 ..... Tube Support Clamp ..... T18-105

**19B673** **Barrel Sightglass**  
58-64 ..... Barrel Sightglass\* ..... 13-400  
58-64 ..... Copper Washers, New, ea ..... 13-403  
58-64 ..... Glass Insert, New ..... 13-402  
58-64 ..... Male Quick-Disconnect Port ..... 14-121  
58-64 ..... Sightglass Rebuild Kit+ ..... 13-401  
*\* Outright Core Charge, Add ..... C-BSG  
+ Includes Glass Insert, O-Rings & Copper Washers*

**2882** **Compressor Mounting Bracket**  
64 ..... Compressor Mount ..... 07-103F  
65-66 ..... Compressor Mount ..... 07-104F

**2884** **Compressor Clutch & Pulley Assembly**  
61-64 ..... Compressor Clutch FE \* ..... 08-119  
65-66 ..... Compressor Clutch\* ..... 08-102  
58-66 ..... Clutch Bearing, New ..... 08-108  
*\* Outright Core Charge, Add ..... C-050*

## 1964-1966

## Engine Compartment

**2888 Compressor Brace - Front**  
 64..... Front Support Tube..... T07-102  
 65-66 ..... Front Support Tube..... T07-103

**2889 Compressor Brace - Rear**  
 64..... Rear Compressor Brace..... T07-104  
 65-66 ..... Rear Compressor Brace..... T07-105

**2979 Brush Set - Compressor Clutch**  
 64-66 ..... Clutch Brush Set..... 08-107

**2990 Bearing - Clutch/Idler**  
 64-66 ..... Idler Bearing Kit w/Cover..... 07-168

**6312 Pulley - Crankshaft with A/C**  
 64-66 ..... Crank Pulley..... 07-114F

**8146 Fan Shroud**  
 64-65 ..... Fan Shroud LH..... T09-104  
 64-65 ..... Fan Shroud RH..... T09-105  
 64-65 ..... Fan Shroud RH/LH..... T09-106  
 66..... Fan Shroud 17"..... T09-107  
 66..... Fan Shroud 19"..... T09-108

**8287 Hose Clamp - Heater Hose**  
 59-66 ..... Heater Hose Clamp..... 18-109

**8509 Pulley - Waterpump**  
 64..... Waterpump Pulley..... 07-118F  
 65-66 ..... Waterpump Pulley..... 07-119F

**8600 Fan - Engine Cooling**  
 64-66 ..... Engine Fan, Orig. .... T09-112  
 17" 6-Blade Engine Fan..... 09-113  
 18" 6-Blade Engine Fan..... 09-114

**8678 Pulley - Idler & Bracket**  
 64-66 ..... Adjustable Idler\*..... 07-105F  
 64-66 ..... Non Adj. Idler w/o PS+..... 07-106F  
 64-66 ..... Non Adj. Idler with PS\*..... 07-107F  
 \* Outright Core Charge, Add..... C-030  
 + Outright Core Charge, Add..... C-020

**8679 Pulley - Idler Pulley Only**  
 64-66 ..... Idler Pulley Only..... 07-174

**8680 Idler - Mounting Plate**  
 64-66 ..... Adjustable Idler Plate..... 07-109F  
 64-66 ..... Non Adjustable Idler Plate..... 07-110F  
 64-66 ..... Non Adjustable Idler Support..... 07-108F

**8A616 Clutch - Engine Fan**  
 61-66 ..... Fan Clutch..... n/a

**Figure 1: Externally Equalized**

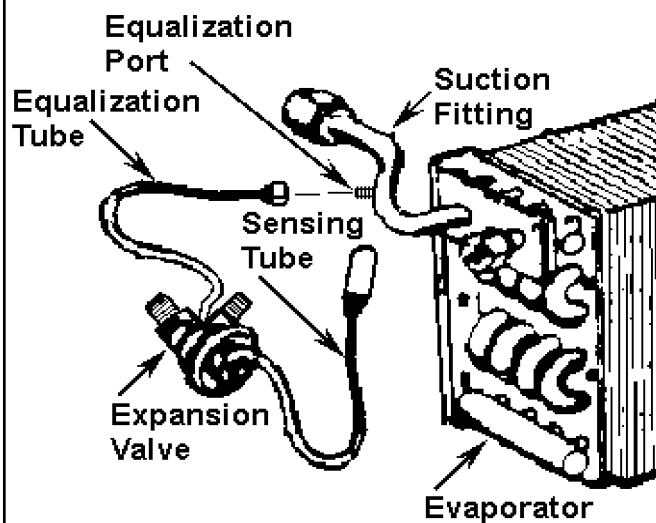

- Uses equalization port on the evaporator suction fitting.
- Uses second capillary tube (equalization tube) on the expansion valve to connect to the equalization port on the evaporator.

**Figure 2: Internally Equalized**

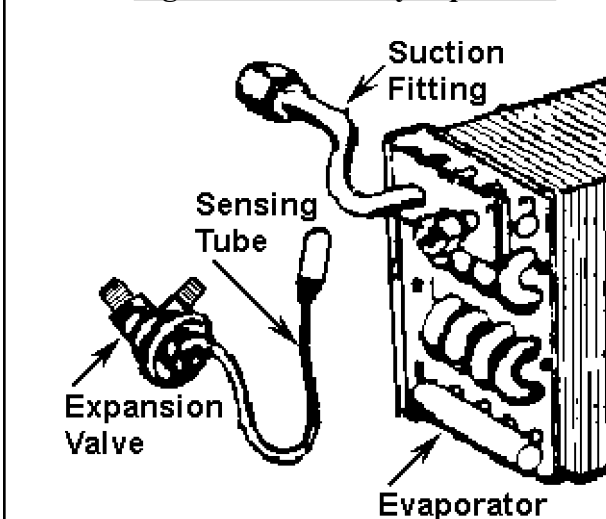

- Does not use equalization port on the evaporator and does not have a second capillary tube (equalization tube) on the expansion valve.

### **PLEASE NOTE:**

- The new replacement internally equalized 58-66 expansion valve (#15-101) can be used to replace a externally equalized expansion valve simply by capping off the equalization port on the evaporator.
- Slightly different hose routing may be required when using the #15-101 1958-66 expansion valve as valve length is not exactly the same.

# 1967 and Newer \_\_\_\_\_ Thunderbird

## 19710 \_\_\_\_\_ Condensers

67-69 .....	Condenser .....	11-112
70-71 .....	Condenser .....	11-113
72-74 .....	Condenser .....	11-114
75-76 .....	Condenser.....	11-115
77-79 .....	Condenser 18" Tall.....	11-117
78.....	Condenser 16" Tall.....	11-116
80-81 .....	Condenser .....	11-118



# 1958 - 1966

## 19655 Compressor Shaft Seal Kit

Tecumseh Early Shaft Seal Kit*	05-112
Tecumseh Late Shaft Seal Kit†	05-113
York Early Shaft Seal Kit	05-114
York Late Shaft Seal Kit	05-115
York Current Shaft Seal Kit	05-126

## 19656 Compressor Valve Plate

Tecumseh Valve Plate	05-116
York Smooth, Finned & Early Valve Plate	05-117
York Late Valve Plate	05-118

### York Shaft Seal Styles

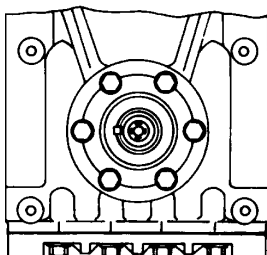

**Late →**  
**5 Bolts,**  
**7/16" Heads**

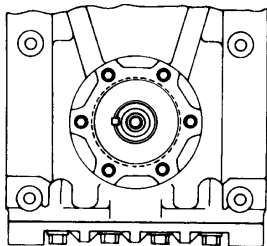

**← Finned, Smooth  
& Early**  
**6 Bolts, 3/8" Heads**  
**9/32" Holes**

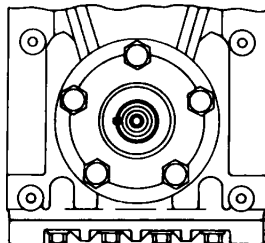

**← Current**  
**6 Bolts, 1/4" Heads**  
**7/32" Holes**

# A/C Compressor Parts

## 19752 Compressor Service Valve w/ Caps

58-61	Dis. Service Valve	14-115
58-61	Suct. Service Valve	14-116
58-61	Dis. Service Valve,	14-115R
58-61	Suct. Service Valve, Repl.	14-116R
58-61	Flange Gasket, New, each	14-117
62-66	Discharge Service Valve, New	14-101
62-66	Suction Service Valve, New	14-102
58-61	Steel Bullet Cap, each	14-107S
62-66	Bullet Cap Set, New, pair*	14-107
58-66	Brass Service Port Cap, New	14-108

## 19B684 Gasket Set

58-63	Finned/Smooth York Gasket Set	
64½-73	Tecumseh Gasket Set	05-119
64½-73	York Gasket Set	05-120

## 19B994 Seal - Service Valve

64½-69	Rotolock Seal	14-113
58-61	Flange Gasket, New, each	14-117

## 2995 Cylinder Head

Finned York Flange Head	
York Rotolock Cylinder Head	05-121
York Tube-O Cylinder Head	05-122
Tecumseh Roto Cylinder Head	05-123
Tecumseh Tube-O Cylinder Head	05-124

## Lubricant

R-12 Oil 11oz. Bottle	05-125
134a Oil 12oz. Bottle	05-127

**See Page 19 For  
Information On Our  
Sanden Compressor  
Conversion Kits!**

## Tecumseh

## Bolt Torque Requirements

## York

Location	Torque	Location	Torque
Cylinder Head	20-24 ft-lbs	Base Plate	Hex 12-18 ft-lbs
Service Valve-Hex Head	20-24 ft-lbs	Connecting Rod	12 point 12-16 ft-lbs
Service Valve-12 point Socket Head	20-24 ft-lbs	Rear Bearing Cover Plate	Flat 9-17 ft-lbs
Service Valve-Socket Head	20-24 ft-lbs	Cylinder Head	Hex 15-23 ft-lbs
Crankshaft End	15-20 ft-lbs	Seal Plate	Hex 5-7 ft-lbs
Seal Plate	6-10 ft-lbs	Service Valve	Hex 15-23 ft-lbs
Mounting	14-17 ft-lbs	Shipping Flange	Hex 15-23 ft-lbs
Front Bearing Lock Bolts	6 ft-lbs	Seal Cap	Round 7-10 ft-lbs
Connecting Rod	7 ft-lbs	Rotolock Valve	Hex 30-35 ft-lbs
Oil Filler Plug	18-22 ft-lbs	Mounting Screw	User's Choice 25 ft-lbs*
Rotolock Nut	65-70 ft-lbs	Oil Fill Plug	Hex 4-11 ft-lbs
		Clutch Bolt (Part of Clutch)	Hex Per Clutch Mfr.

\*Determined by type used



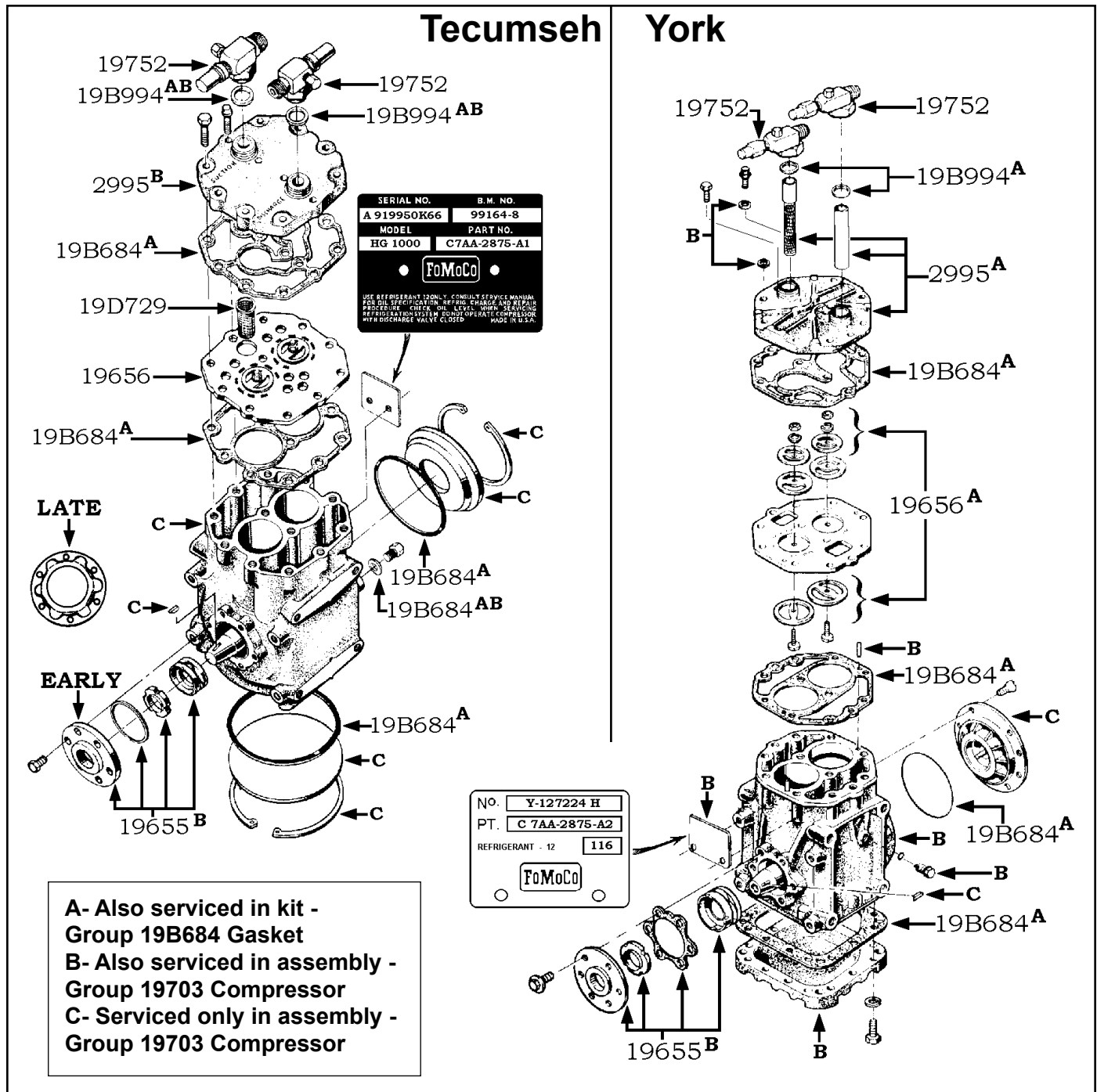
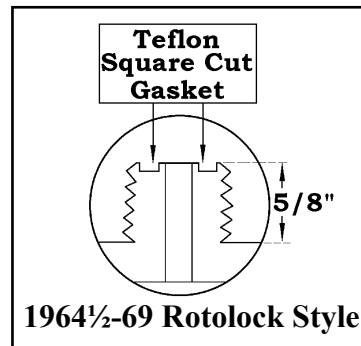
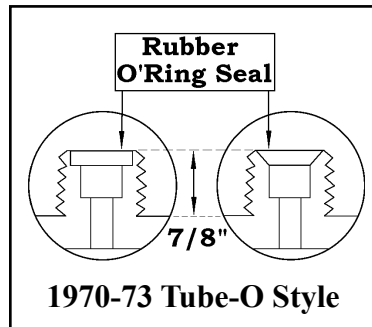

# Sanden Compressor Conversion Kits

- ☑ Eliminates rumble, vibration and belt slap
- ☑ 6,000 R.P.M. continuous-duty rating
- ☑ Less horsepower, better fuel economy and performance

- ☑ Original style hose assemblies for proper fit
- ☑ Easy to install with NO modifications to car
- ☑ Half the weight & bulk of stock compressor
- ☑ Clean and attractive under-hood appearance

☑ Our high-performance **134a** and **R12** Sanden conversions are supplied with a Sanden compressor, and all required adapter brackets and suction & discharge hoses. All hose assemblies are all pre-crimped and ready to install. Excellent attention to detail makes for a very attractive under-hood appearance and an easy installation.

☑ **134a Conversion Kits** are identical to the R12 Kit except supplied with 134a compressor and proper hose fittings for system charging. 134a removes a higher heat load from the interior, so it is extremely important for the fan clutch and condenser to be in excellent condition on any 134a conversion. In addition, the system must be cleaned and properly vacuum pumped to remove any trace amounts of contaminants and moisture vapor.

☑ If you drive your Thunderbird daily, then our extremely popular Sanden conversion is a must have option for your factory A/C system. We'll even take your old compressor and clutch as trade, or buy it outright when your installation is finished.

☑ We will also buy your original 1958-63 compressor core for \$50 and clutch all cores for \$30 (rebuildable cores only.) when returned with a copy of the invoice with your Sanden Conversion Kit.

NOTE: It is extremely important that the filter-drier is replaced or rebuilt any time the system is opened to the atmosphere. Classic Auto Air can rebuild your original core for you.

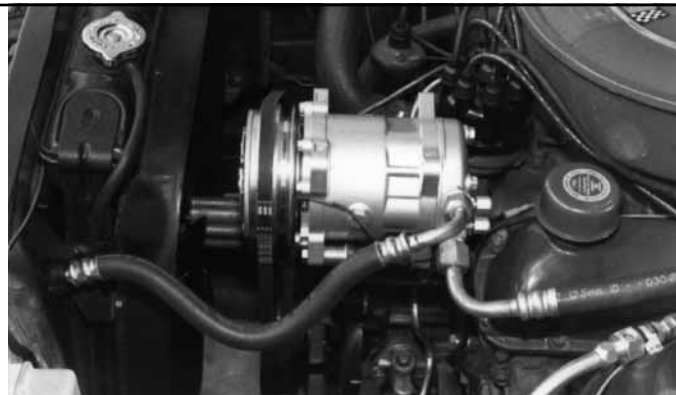

**R-12 5-107**  
**134a 5-128**

## R-12 Kits

58-60 T-Bird Rotary Kit R-12 .....	23-130R
61-65 T-Bird Rotary Kit R-12 .....	23-131R
66 T-Bird Rotary Kit R-12 .....	23-132R

## 134a Kits

58-60 T-Bird Rotary Kit 134a .....	23-130
61-65 T-Bird Rotary Kit 134a .....	23-131
66 T-Bird Rotary Kit 134a .....	23-132

All kits include compressor, suction hose, discharge hose & adapter bracket.  
1-year warranty is provided, provided proof of replacement filter-drier is provided.

**These kits DO NOT include a filter-drier, but we can also custom-rebuild your original filter-drier.**

## R-12 vs. 134a

All 1958-66 Thunderbird systems will perform equally with either refrigerant. No major component change is needed to convert your R-12 systems to 134a. When converting to 134a, but the system must be clean and free of contaminants, a new or rebuilt filter-drier must be installed & the correct 134a compatible oil must be used.

# ASK US ABOUT A SANDEN CONVERSION KIT FOR ALL OF YOUR 55-75 FORD, GM & CHRYSLER CARS & TRUCKS!



7-107F



7-108F



7-168



11-107

19-109



8-102



8-107



16-101

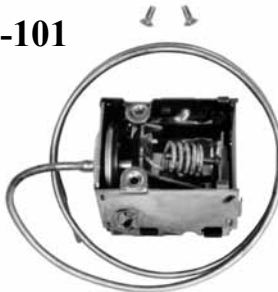

19-104



5-101



5-111



14-101



14-103



14-107

14-112



Female 14-110

Male 14-111



**A catalog to suit your classic!  
all back by the best tech support  
on the planet!**



### **THE MUSTANG A/C EXPERTS!**

The most comprehensive Mustang catalog ever! This catalog covers 1964-73 Mustang, 1967-73 Cougar, 1964-65 Falcon, Ranchero & Comet.

Packed with information on our complete original and high performance aftermarket systems, factory a/c system upgrade kits and the most factory A/C and heater parts for your classic Ford than any catalog in print! Also includes exploded diagrams to make it easier to find the parts you need!

AVAILABLE FOR IMMEDIATE DOWNLOAD  
[www.classicautoair.com/download-catalog.html](http://www.classicautoair.com/download-catalog.html)

### **THE MODEL SPECIFIC & CUSTOM A/C EXPERTS!**

We have the most model specific high performance air-conditioning systems of anyone in the industry!

Packed with information on over fifty model specific Perfect Fit™ Series air-conditioning systems and options, including every A/C part you need to build your own custom system kit.

AVAILABLE FOR IMMEDIATE DOWNLOAD  
<https://originalair.com/catalogs>



### **THE FACTORY A/C RESTORATION EXPERTS!**

Camaro, Charger or Fairlane, Skylark or Firebird, we can help! This catalog covers 1970's & older Ford, General Motors & Mopar.

Packed with replacement parts, restoration services for nearly every part in your , model specific high-performance factory a/c compressor upgrade kits, model specific engine compartment upgrade kits, information on converting to 134a and more!

AVAILABLE FOR IMMEDIATE DOWNLOAD  
<https://originalair.com/catalogs>







## A day in the life of the Classic Auto Air Team



## Classic Auto Air Manufacturing LP

(866) 352-4678

FAX (813) 254-7419  
5133 W Idlewild Ave,  
Tampa, FL 33634.

© 2016

